



**Citizens' Bond Oversight Committee
Quarterly Report
November 18, 2019**

Santa Ana Unified School District
1601 E. Chestnut Avenue, Santa Ana, CA 92701
(714) 558-5501 www.sausd.us





Measure I Overview

On November 6, 2018, the voters of the Santa Ana Unified School District approved Measure I, authorizing General Obligation Bonds (the “Bonds”) with a 70.65% approval rate. Measure I generates \$232 million dollars over the next 10-15 years to improve and build new classrooms and support facilities in the District.

The Facilities Master Plan adopted by the District’s Board of Education in 2018 will serve as the guide to plan projects funded by Measure I. School needs are based on overall condition, educational program requirements, capacity, and available State funding. The Bonds will be used to modernize classrooms and buildings with accessibility improvements and safety upgrades, as well as to repair and upgrade aging school infrastructure, replace portable classrooms with permanent facilities, and keep schools ahead of the demands of 21st Century learning environments.

Committee Members

- ❖ Victor Vasquez – Chair
- ❖ Denise Lynn Reynoso – Vice Chair
- ❖ Elaine Beverly Hoffmann – Member
- ❖ Rob Lee Richardson - Member
- ❖ Lucinda Solorzano – Member
- ❖ Valery Vasquez – Member
- ❖ Bulmaro Vicente - Member



Four Pillars

The Facilities Master Plan was guided by a “Four Pillars” concept to meet the needs of aging schools so that our community keeps pace with rising academic standards and opportunities to compete in the 21st Century.

Projects identified by the Facilities Master Plan generally correspond to one or more of the priorities described below.



Modernization:

The State Modernization Program provides State funds on a 60/40 State and local share basis for improvements that educationally and functionally enhance existing school facilities. Projects eligible under this program include Americans with Disability Act improvements, modifications such as air conditioning, plumbing, lighting, electrical systems, and interior finishes. Bond funds will be used to leverage State dollars and improve age-eligible schools.

Portable to Permanent (P2P):

The replacement of antiquated portables with state-of-the-art classroom learning environments help save on maintenance and energy costs and recapture open space for student play and community use. Combining State Overcrowded Relief Grant (ORG) fund savings and bond funds allow for projects including, but not limited to:

- ❖ Carver Elementary P2P
- ❖ Muir Elementary P2P
- ❖ Jefferson Elementary P2P



Infrastructure:

The replacement or improvement of antiquated building systems such as HVAC, plumbing, electrical, fire alarms, and other critical functions help reduce the District's maintenance burden and thus sustain the District's General Fund for educational programs. A focus of bond funds will be:

- ❖ Enhancing student and staff safety and security
- ❖ Improving services to clients (students, faculty and staff)
- ❖ Reducing interruptions to education delivery

Campus Equity:

Our schools were built over many generations, all with a variety of features and functions that vary by location. Funds will be used to provide facilities which serve all of our District community and correct inequities between campuses to keep them on par with peer schools. Goals include:

- ❖ Safe, effective, and well-maintained learning environments
- ❖ Facilities that maintain and attract enrollment and which support and enhance academic achievement
- ❖ Opportunities for parent involvement and community services

Available Funding

Measure I represents approximately 10% of the District's identified need. Within the \$232 million authorized by Measure I, about 25%, or \$59.5 million, is available for current projects.

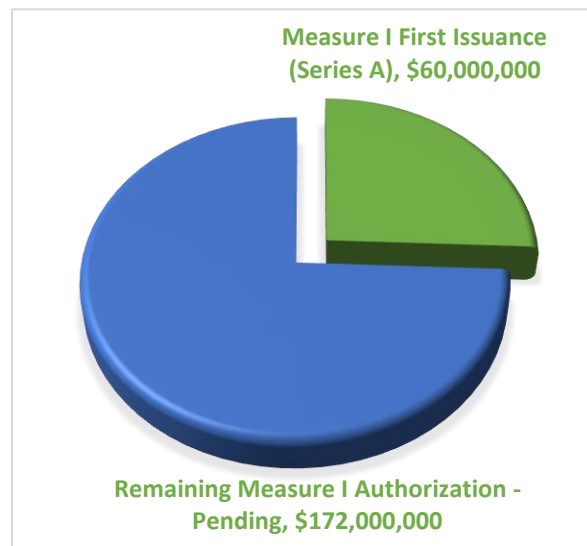
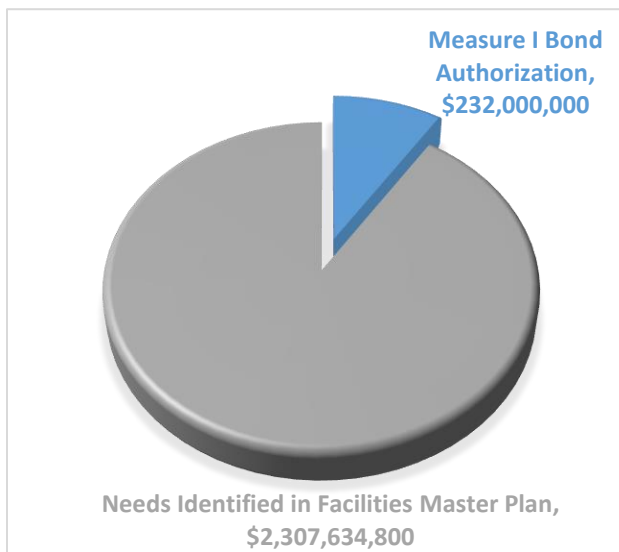



Santa Ana High School

520 W. Walnut St. Santa Ana, CA 92701

New Library and CTE Digital Media Arts Lab

Project Description

The District's goal for moving forward with this project was to provide an exemplary Career Technical Education (CTE) environment for our students and staff. The project began on September 24, 2018 and was completed on September 1, 2019. The Digital Media Arts Lab and library are now being used by students and staff.

Architect:	Baker Nowicki Design Studio
DSA Status:	Approved
Project Status:	Complete
Measure I Budget:	\$50,000
Total Budget:	\$5,708,225

Status Summary

After occupancy, it was discovered that the noise levels needed to be addressed in the library. The architect's acoustic engineer addressed the issue by creating a plan to install acoustical panels. Additional work will also be conducted to replace two safety screens in the south stairwell using Measure I funding.



Santa Ana High School

520 W. Walnut St. Santa Ana, CA 92701

New Library and CTE Digital Media Arts Lab

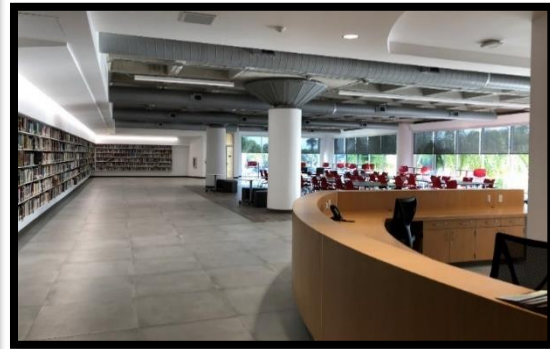
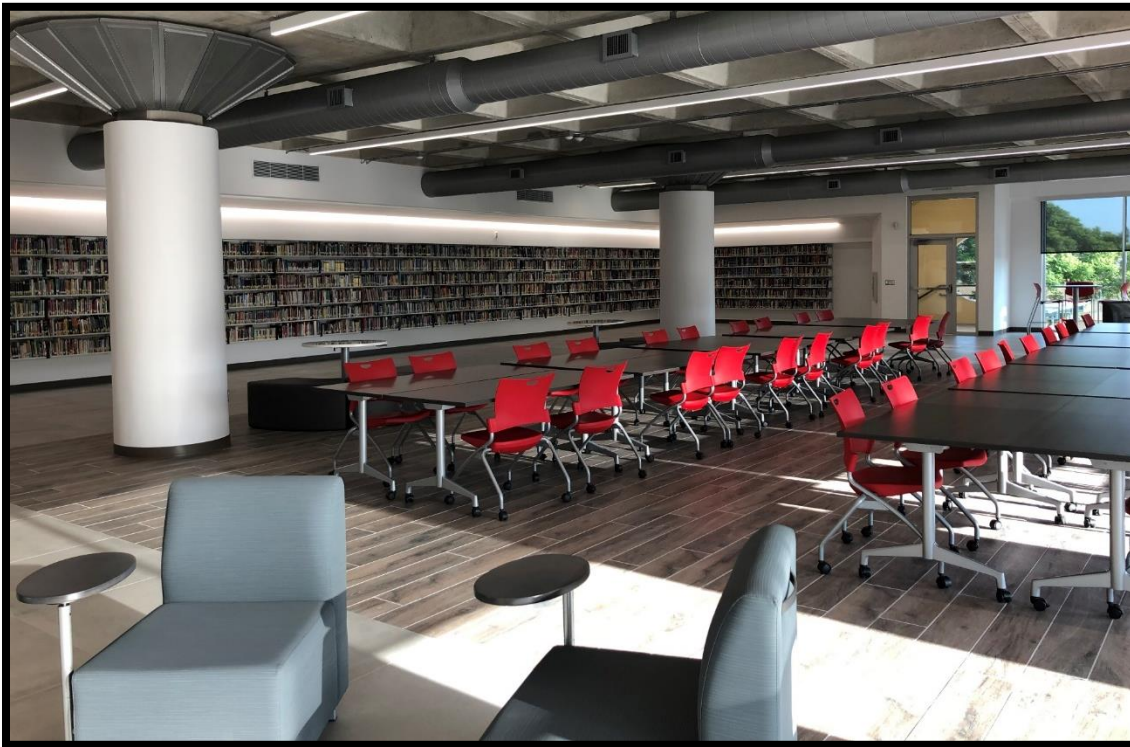



Santa Ana High School

520 W. Walnut St. Santa Ana, CA 92701

New Library and CTE Digital Media Arts Lab

Summary Status

Description	Budgeted	Committed	Expended
Site Cost	-	-	-
Soft Cost	767,129	766,261	669,295
Hard Cost	4,854,000	4,709,251	4,539,764
Contingency	87,096	-	-
Total	5,708,225	5,475,511	5,209,059
Budgeted Hard Cost 85.0%			

Budget Status

Initial Amount	5,708,225
Pending Changes	-
Total	5,708,225
Budgeted Contingency 1.5%	

Committed Status

Initial Contracted AMT	5,242,519
Contract Changes	232,992 4.3%
Total	5,475,511
Budget Committed 95.9%	

Expenditure Status

Paid	4,760,658
In Process for PMT	221,939
District Held Retentions	226,462
Total	5,209,059
Budget Expended 91.3%	

Progress

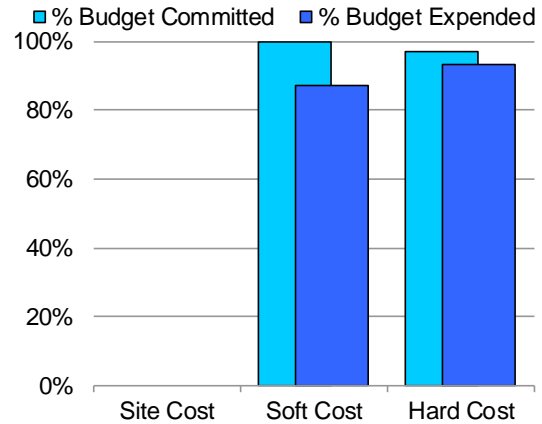

Funding Sources

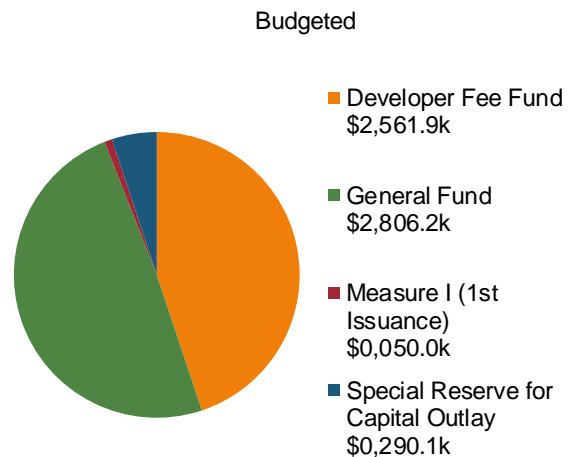



Carver Elementary School

1401 W. Santa Ana Blvd., Santa Ana, CA 92703

Portable to Permanent (P2P)

Project Description

The Carver P2P project consists of a new 2-story classroom building with 8 classrooms. The project also provides expanded play areas, an artificial turf play field, new play structures, and added parking.

Architect:	Morrissey Associates, Inc.
Construction Manager:	Tilden-Coil Constructors, Inc.
DSA Status:	Approved
Project Status:	Construction Began: February 14, 2019
Measure I Budget:	\$980,391
Total Budget:	\$11,167,378

Status Summary

The Carver P2P Project is currently under construction. The project is scheduled for completion in December 2019, which is approximately 2 months ahead of schedule. The site is scheduled to move in to the new building on or after December 23, 2019.



Carver Elementary School

1401 W. Santa Ana Blvd., Santa Ana, CA 92703

Portable to Permanent (P2P)

E





Carver Elementary School

1401 W. Santa Ana Blvd., Santa Ana, CA 92703

Portable to Permanent (P2P)

Summary Status

Description	Budgeted	Committed	Expended
Site Cost	20,534	20,534	18,259
Soft Cost	2,224,436	2,115,952	1,587,659
Hard Cost	8,918,955	8,803,010	5,546,546
Contingency	3,453	-	-
Total	11,167,378	10,939,496	7,152,465

Budgeted Hard Cost 79.9%

Budget Status

Initial Amount	11,167,378
Pending Changes	-
Total	11,167,378

Budgeted Contingency 0.0%

Committed Status

Initial Contracted AMT	10,880,134
Contract Changes	59,362 0.5%
Total	10,939,496

Budget Committed 98.0%

Expenditure Status

Paid	6,929,097
In Process for PMT	53,206
District Held Retentions	170,162
Total	7,152,465

Budget Expended 64.0%

Progress

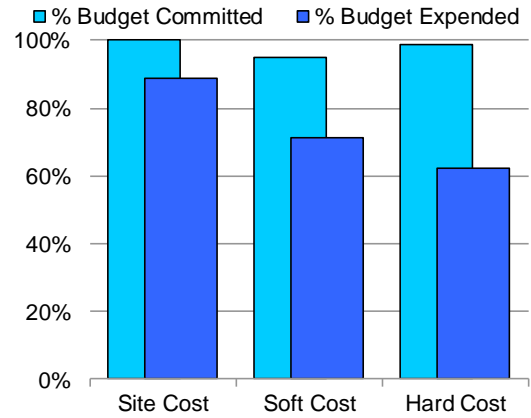

Funding Sources

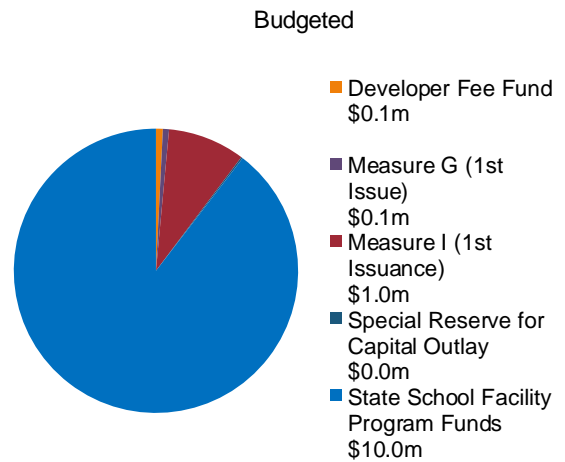



Muir Fundamental Elementary School

1951 N. Marbury St. Santa Ana, CA 92705

Portable to Permanent (P2P)

Project Description

Muir Fundamental Elementary School was originally built in 1970. The site currently has 22 aging portable classrooms. This project consists of a state-of-the-art new “Portable to Permanent” classroom building providing 22 standard classrooms with 4 multi-function “STEM” collaboration/ pull out rooms. It also includes removal of old portable classrooms and an expanded playfield.

Architect:	DLR Group
Construction Manager:	Balfour Beatty
DSA Status:	Approved
Project Status:	Construction Began: October 14, 2019
Measure I Budget:	\$759,154
Total Budget:	\$20,759,154

Status Summary

Construction is 45% complete on the Silver Creek module segments that will be assembled upon completion of the building foundation. Construction for the building foundation, utilities and hardscape began on October 14, 2019 with project scheduled to be substantially completed on June 30, 2020.



Muir Fundamental Elementary School

1951 N. Marbury St. Santa Ana, CA 92705

Portable to Permanent (P2P)





Muir Fundamental Elementary School

1951 N. Marbury St. Santa Ana, CA 92705

Portable to Permanent (P2P)

Summary Status

Description	Budgeted	Committed	Expended
Site Cost	-	-	-
Soft Cost	5,372,600	2,629,635	1,307,563
Hard Cost	13,146,074	11,450,661	3,265,881
Contingency	2,240,480	-	-
Total	20,759,154	14,080,296	4,573,444

Budgeted Hard Cost 63.3%

Budget Status

Initial Amount	20,759,154
Pending Changes	-
Total	20,759,154

Budgeted Contingency 10.8%

Committed Status

Initial Contracted AMT	14,906,383
Contract Changes	(826,087) -5.9%
Total	14,080,296

Budget Committed 67.8%

Expenditure Status

Paid	4,541,023
In Process for PMT	8,588
District Held Retentions	23,833
Total	4,573,444

Budget Expended 22.0%

Progress

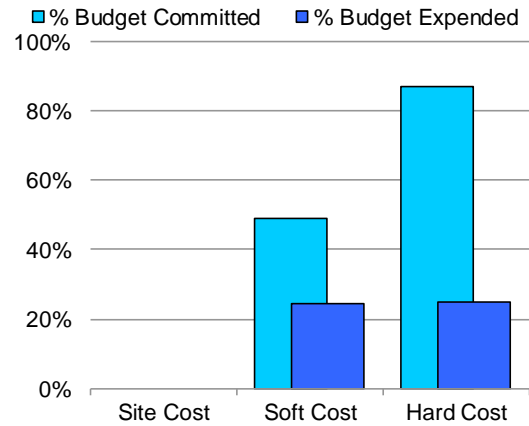

Funding Sources

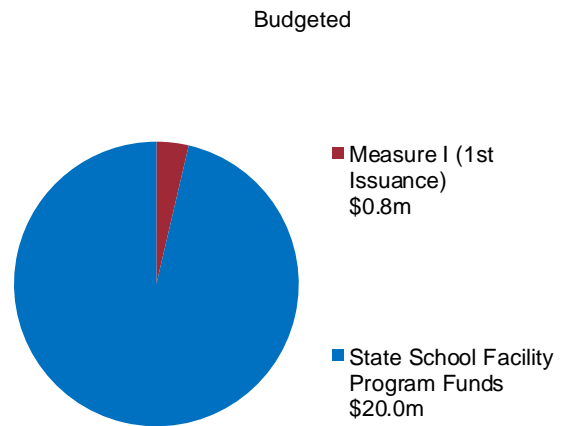



Carver Elementary School

1401 W. Santa Ana Blvd., Santa Ana, CA 92703

Modernization

Project Description

Carver Elementary was originally built in 1992. The site has 21 classrooms. Carver's modernization project consists of alterations to Building A (administration); Building B (multipurpose); and Buildings E, F, G (classrooms).

Architect:	Morrissey Associates, Inc.
Construction Manager:	Tilden Coil Constructors, Inc.
DSA Status:	Approved
Project Status:	Pending Bid
Measure I Budget:	\$8,815,632
Total Budget:	\$9,577,806, pending Board approval

Status Summary

The Carver Modernization project was State approved in late 2018. The project team has been meeting on a regular basis to refine project details, adapt to current construction costs, and prepare for bidding on November 12, 2019.



Carver Elementary School

1401 W. Santa Ana Blvd., Santa Ana, CA 92703

Modernization

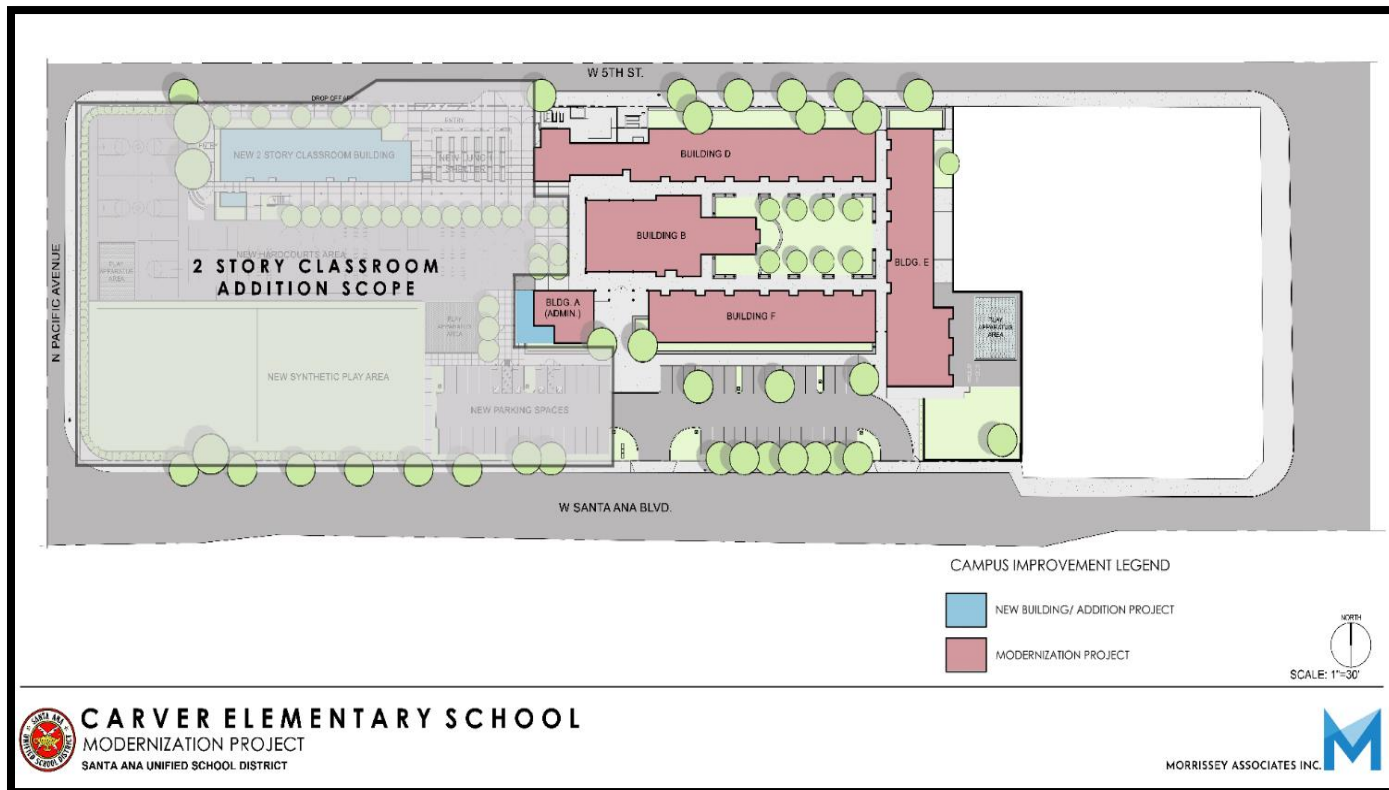



Carver Elementary School

1401 W. Santa Ana Blvd., Santa Ana, CA 92703

Modernization

Summary Status

Description	Budgeted	Committed	Expended
Site Cost	-	-	-
Soft Cost	1,542,314	888,343	548,554
Hard Cost	6,500,000	-	-
Contingency	1,535,492	-	-
Total	9,577,806	888,343	548,554

Budgeted Hard Cost 67.9%

Budget Status

Initial Amount	9,577,806
Approved Changes	-
Pending Changes	-
Total	9,577,806

Budgeted Contingency 16.0%

Committed Status

Initial Contracted AMT	343,139
Contract Changes	545,203 61.4%
Total	888,343

Budget Committed 9.3%

Expenditure Status

Paid	544,020
In Process for PMT	2,663
District Held Retentions	1,871
Total	548,554

Budget Expended 5.7%

Progress

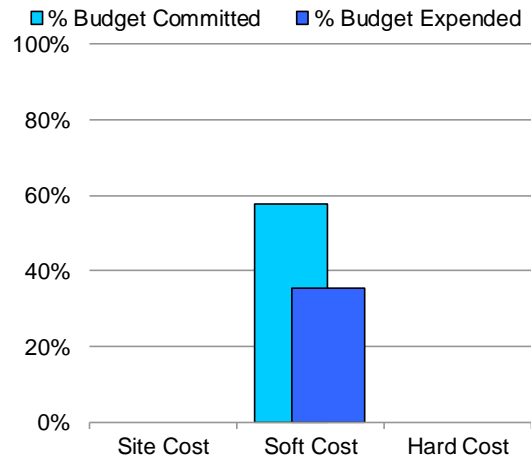

Funding Sources

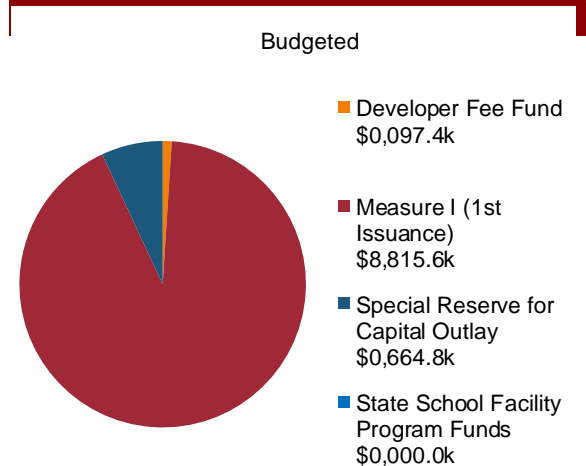



Garfield Elementary School

850 Brown St. Santa Ana, CA 92701

Modernization

Project Description

Garfield Elementary School was originally built in 1989. The site has 35 classrooms. Modernization consists of infrastructure upgrades, library and tech room improvements, office safety, enhancements, and Americans with Disabilities Act (ADA) access improvement.

Architect:	Morrissey Associates, Inc.
Construction Manager:	Tilden Coil Constructors, Inc.
DSA Status:	Approved
Project Status:	Pending Bid
Measure I Budget:	\$7,669,956
Total Budget:	\$8,247,469, pending Board approval

Status Summary

The project was State approved in early 2019 and is currently pending State matching funds which are anticipated in 2020. The District will begin bidding and preparation for construction this winter. Board consideration of a responsive bidder is tentatively scheduled for January 2020, with construction starting in June 2020.



Garfield Elementary School

850 Brown St. Santa Ana, CA 92701

Modernization

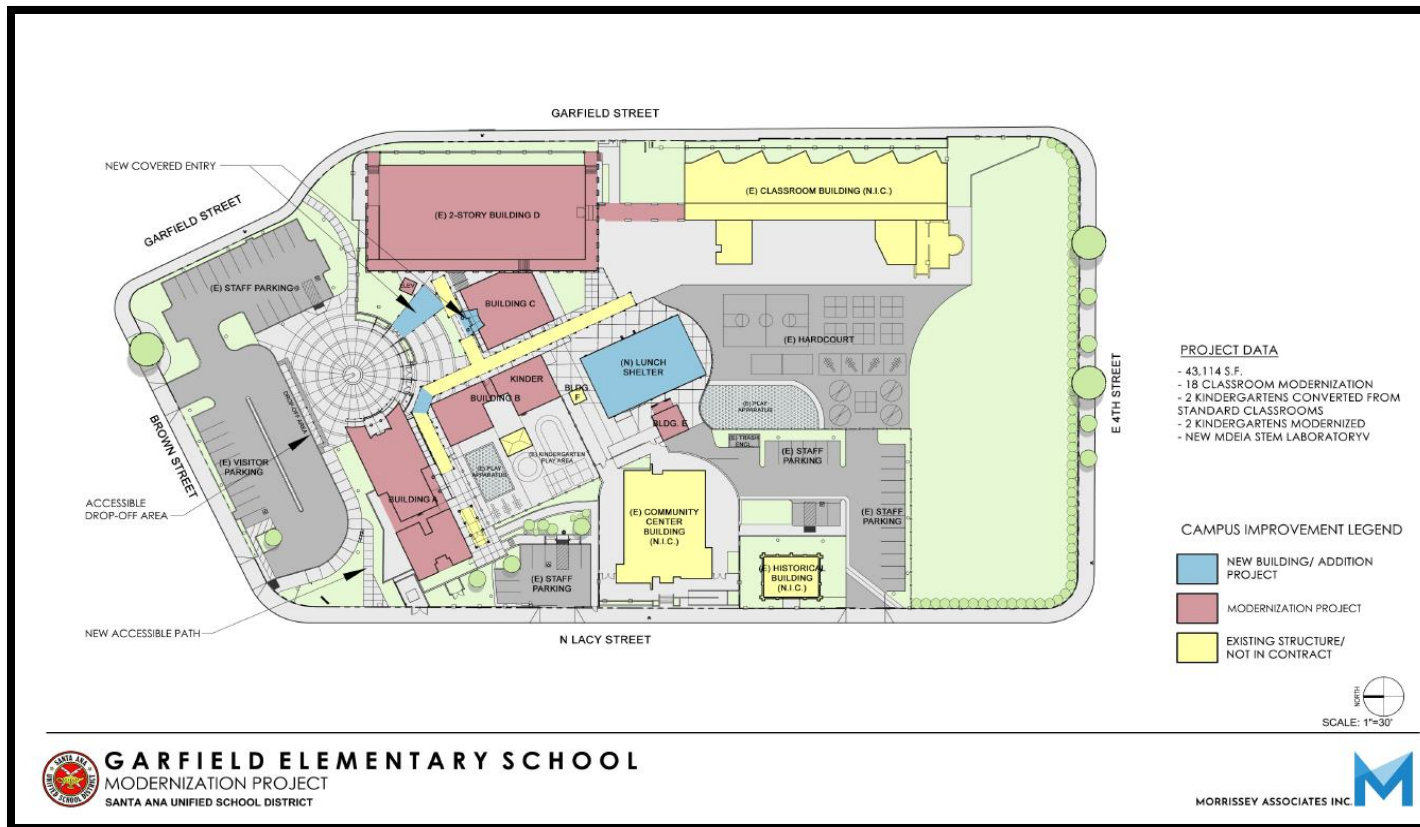



Garfield Elementary School

850 Brown St. Santa Ana, CA 92701

Modernization

Summary Status

Description	Budgeted	Committed	Expended
Site Cost	-	-	-
Soft Cost	1,387,203	807,820	498,803
Hard Cost	6,500,000	-	-
Contingency	360,266	-	-
Total	8,247,469	807,820	498,803

Budgeted Hard Cost 78.8%

Budget Status

Initial Amount	8,247,469
Pending Changes	-
Total	8,247,469

Budgeted Contingency 4.4%

Committed Status

Initial Contracted AMT	636,817	
Contract Changes	171,003	21.2%
Total	807,820	

Budget Committed 9.8%

Expenditure Status

Paid	496,774
District Held Retentions	2,028
Total	498,803

Budget Expended 6.0%

Progress

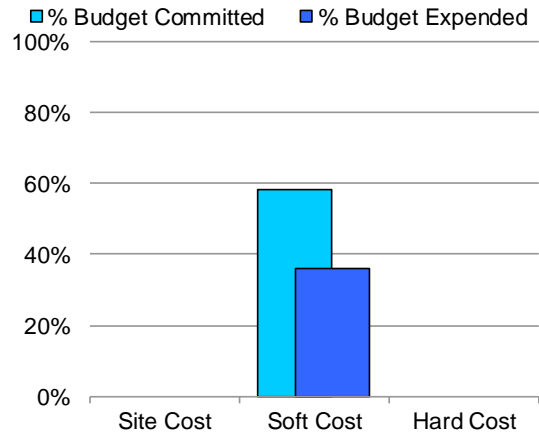

Funding Sources

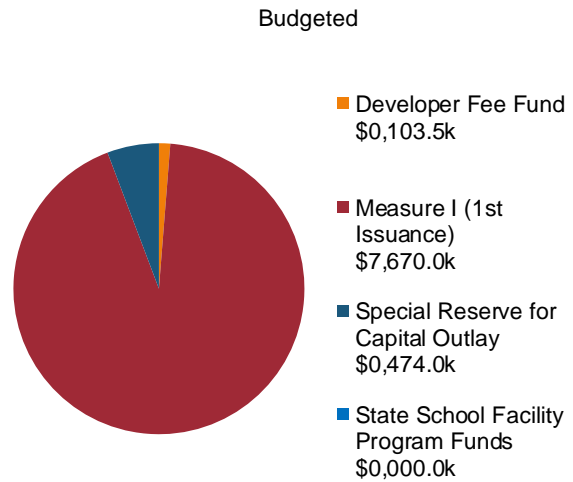



King Elementary School

1001 S. Graham Ln. Santa Ana, CA 92703

Modernization

Project Description

King Elementary School was originally built in 1991. The site has 39 classrooms. Modernization consists of infrastructure upgrades, library and tech room improvements, office safety, enhancements, and Americans with Disabilities Act (ADA) access improvement.

Architect:	Morrissey Associates, Inc.
Construction Manager:	Tilden Coil Constructors, Inc.
DSA Status:	Approved
Project Status:	Pending Bid
Measure I Budget:	\$6,592,852
Total Budget:	\$7,188,862, pending Board approval

Status Summary

The project was State approved in early 2019 and is currently pending State matching funds which are anticipated in 2020. The District will begin bidding and preparation for construction this winter. Board consideration of responsive bidder is tentatively scheduled for February 2020, with construction starting in June 2020.



King Elementary School

1001 S. Graham Ln. Santa Ana, CA 92703

Modernization

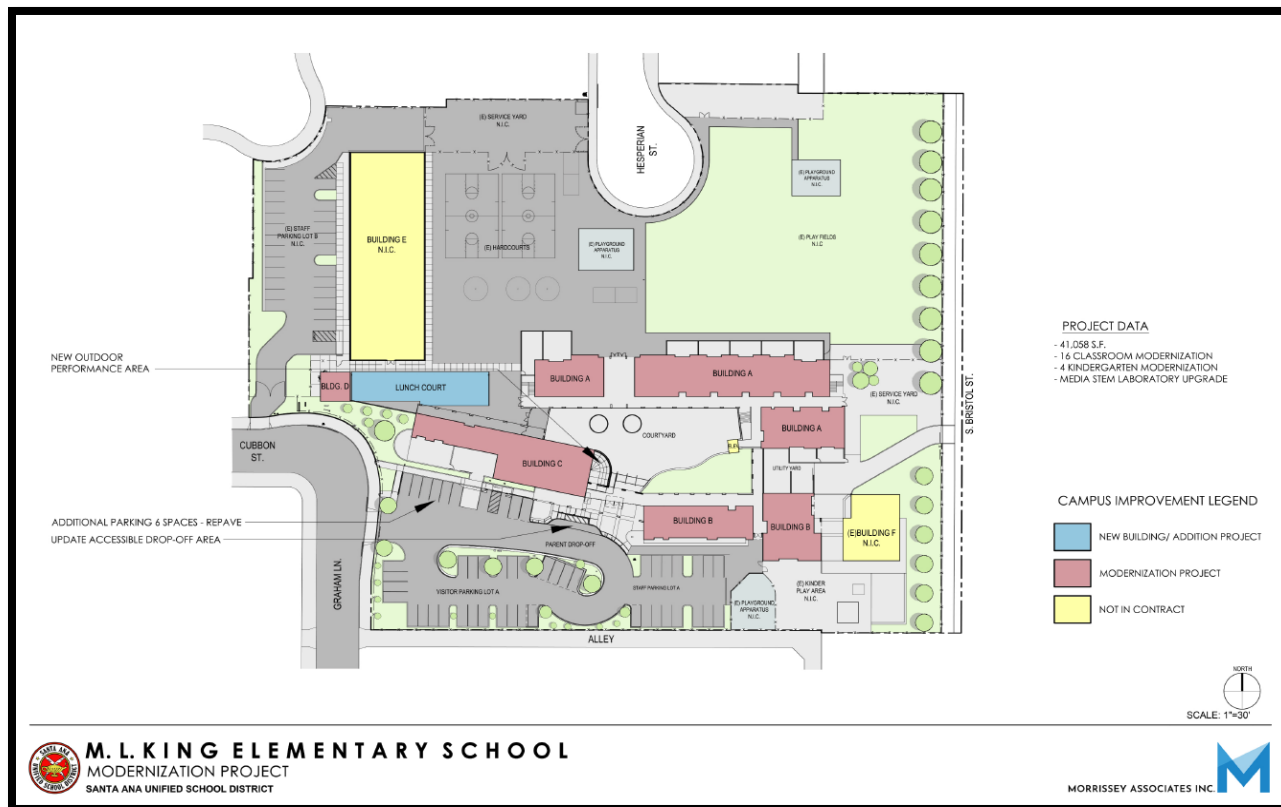



King Elementary School

1001 S. Graham Ln. Santa Ana, CA 92703

Modernization

Summary Status

Description	Budgeted	Committed	Expended
Site Cost	-	-	-
Soft Cost	1,254,075	803,348	499,305
Hard Cost	5,500,000	-	-
Contingency	434,787	-	-
Total	7,188,862	803,348	499,305
Budgeted Hard Cost 76.5%			

Budget Status

Initial Amount	7,188,862
Pending Changes	-
Total	7,188,862
Budgeted Contingency 6.0%	

Committed Status

Initial Contracted AMT	602,148	
Contract Changes	201,200	25.0%
Total	803,348	
Budget Committed 11.2%		

Expenditure Status

Paid	497,439
District Held Retentions	1,866
Total	499,305
Budget Expended 6.9%	

Progress

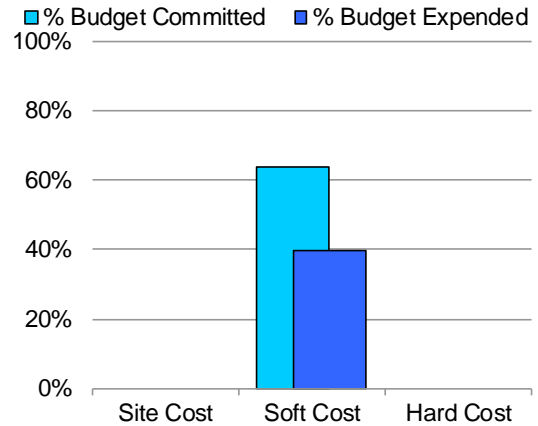

Funding Sources

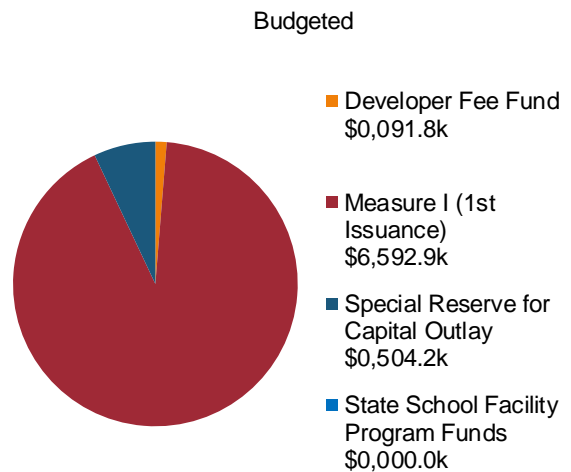



Saddleback High School

2802 S. Flower St. Santa Ana, CA 92707

New Kitchen/Indoor Dining & Interim Kitchen

Project Description

Provides adequately sized kitchen to meet current District standards and offer improved menu. Converts old kitchen into new indoor student dining and event space. Provides interim kitchen during construction.

Architect:	Ruhnau Clark Architects
Construction Manager:	Bernards
DSA Status:	Approved
Project Status:	Pending Bid
Measure I Budget:	\$2,900,000
Total Budget:	\$11,500,000

Status Summary

Project documents were State approved in early 2019, modified to reduce costs in summer 2019, and have been reapproved to allow bidding to proceed. Board consideration of a responsive bidder is tentatively scheduled for February 2020. A bid to proceed with construction of the interim kitchen was awarded on July 30, 2019 and the project is currently under construction with an anticipated completion date by December 31, 2019.



Saddleback High School

2802 S. Flower St. Santa Ana, CA 92707

New Kitchen/Indoor Dining & Interim Kitchen





Saddleback High School

2802 S. Flower St. Santa Ana, CA 92707

New Kitchen/Indoor Dining & Interim Kitchen

Summary Status

Description	Budgeted	Committed	Expended
Site Cost	-	-	-
Soft Cost	2,851,480	2,266,420	758,062
Hard Cost	7,938,000	10,004	10,004
Contingency	710,520	-	-
Total	11,500,000	2,276,424	768,066
Budgeted Hard Cost 69.0%			

Budget Status

Initial Amount	11,500,000
Pending Changes	-
Total	11,500,000
Budgeted Contingency 6.2%	

Committed Status

Initial Contracted AMT	2,186,874	
Contract Changes	89,550	3.9%
Total	2,276,424	
Budget Committed 19.8%		

Expenditure Status

Paid	721,772
In Process for PMT	46,294
Total	768,066
Budget Expended 6.7%	

Progress

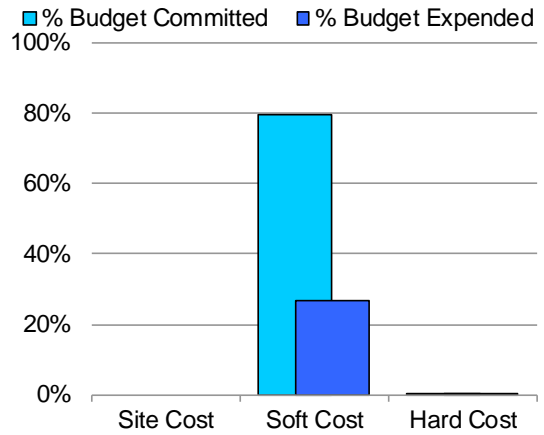

Funding Sources

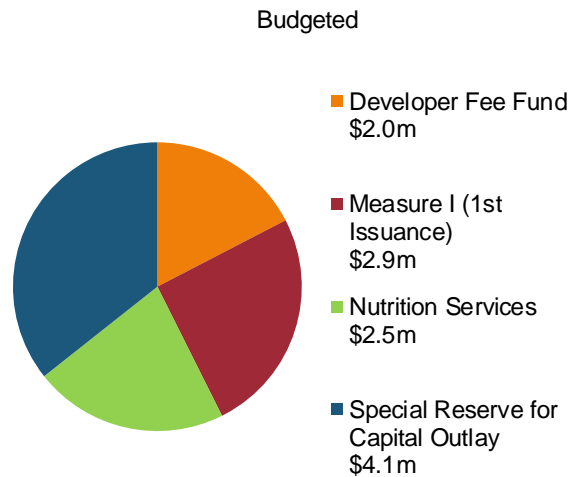



Heninger K-8 School

417 W. Walnut Ave. Santa Ana, CA 92701

K-8 Expansion / Music & Dance Classrooms

Project Description

Heninger serves grades K-8 in its main campus as well as Building 8 at Santa High School. This project provides modern dance and music classrooms as well as support space for upper grade students.

Architect:	Baker Nowicki Design Studio
DSA Status:	Approved
Project Status:	Pending Rebid
Measure I Budget:	\$2,176,821
Total Budget:	\$2,434,147

Status Summary

Following State approval in late 2018, the District bid the project in spring 2019. The Board rejected all bids received in May 2019, as several were non-compliant and the remaining was significantly over budget. Following a redesign, the project is being rebid, however, the two lowest bidders were again deemed non-responsive and bids were rejected by the Board in October 8, 2019. A rebid is now underway.



Heninger K-8 School

417 W. Walnut Ave. Santa Ana, CA 92701

K-8 Expansion / Music & Dance Classrooms

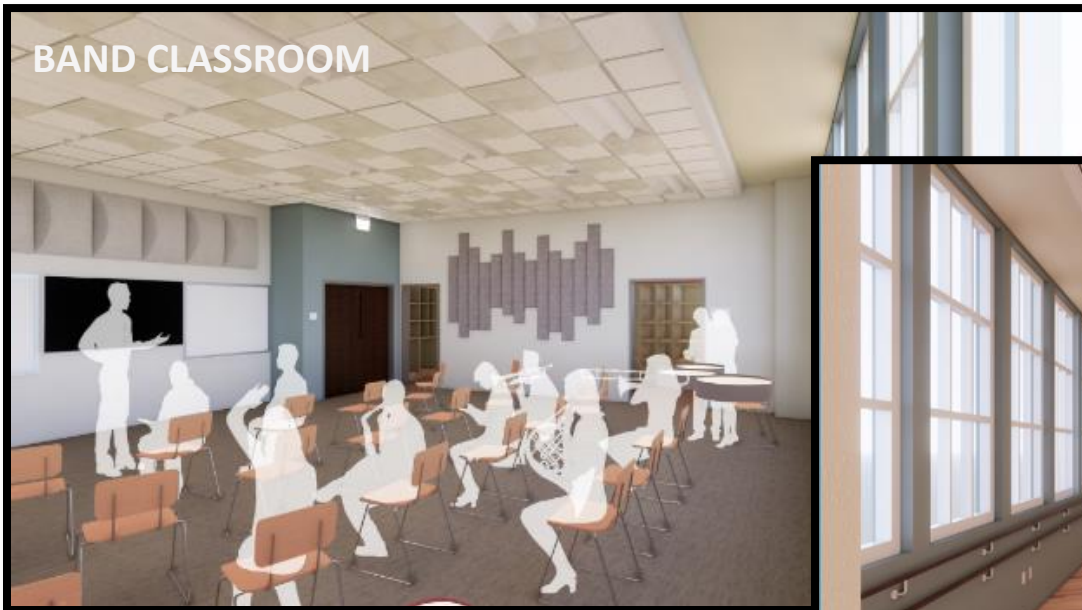



Heninger K-8 School

417 W. Walnut Ave. Santa Ana, CA 92701

K-8 Expansion / Music & Dance Classrooms

Summary Status

Description	Budgeted	Committed	Expended
Site Cost	-	-	-
Soft Cost	618,520	257,326	187,329
Hard Cost	1,785,000	-	-
Contingency	30,627	-	-
Total	2,434,147	257,326	187,329

Budgeted Hard Cost 73.3%

Progress

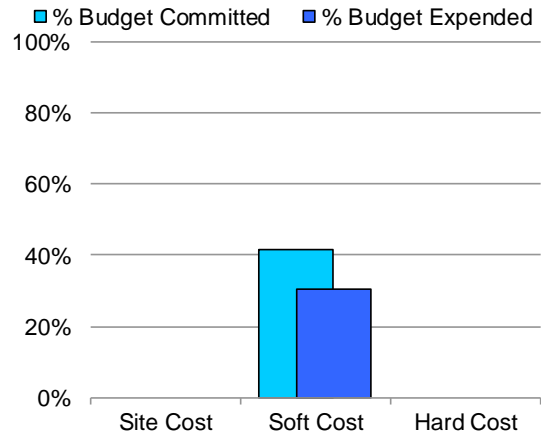

Budget Status

Initial Amount	2,434,147
Pending Changes	-
Total	2,434,147

Budgeted Contingency 1.3%

Committed Status

Initial Contracted AMT	257,326
Contract Changes	- 0.0%
Total	257,326

Budget Committed 10.6%

Expenditure Status

Paid	187,329
Total	187,329

Budget Expended 7.7%

Funding Sources

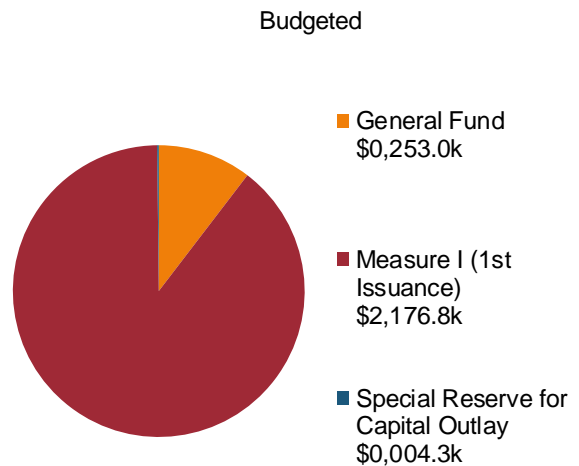



District Wide

Various sites

Marquee Installations

Phase I

Project Description

Electronic message board installations will be designed and installed at the following sites: Madison Elementary, Hoover Elementary, King Elementary, Jackson Elementary, Advanced Learning Academy: Early College Program, Villa Fundamental Intermediate, Chavez High, Carver Elementary, and Washington Elementary.

Architect:	Lionakis Architecture
DSA Status:	Pending Submittal
Project Status:	Planning/Design
Measure I Budget:	\$1,000,000
Project Budget:	\$1,000,000

Status Summary

Planning staff is currently working with the architect to finalize locations, locate underground electrical connections, and prepare for school site review, prior to State submittal.



District Wide

Various sites

Marquee Installations

CARVER ELEMENTARY



HOOVER ELEMENTARY



JACKSON ELEMENTARY



MADISON ELEMENTARY

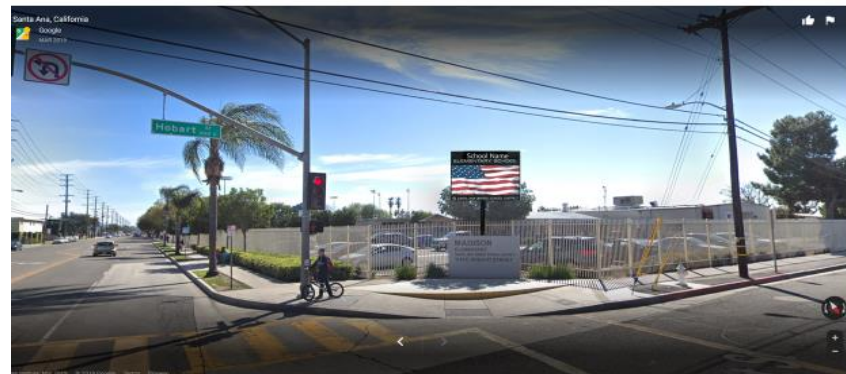



District Wide

Various sites

Marquee Installations

Summary Status

Description	Budgeted	Committed	Expended
Site Cost	-	-	-
Soft Cost	178,600	108,600	10,500
Hard Cost	735,000	-	-
Contingency	86,400	-	-
Total	1,000,000	108,600	10,500

Budgeted Hard Cost 73.5%

Budget Status

Initial Amount	1,000,000
Pending Changes	-
Total	1,000,000

Budgeted Contingency 8.6%

Committed Status

Initial Contracted AMT	109,100	
Contract Changes	(500)	-0.5%
Total	108,600	

Budget Committed 10.9%

Expenditure Status

Paid	10,500
Total	10,500

Budget Expended 1.1%

Progress

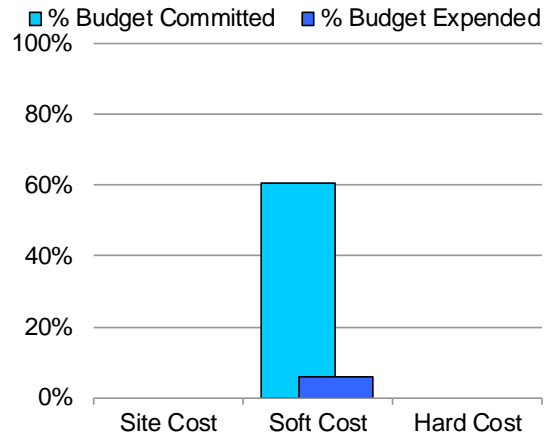

Funding Sources

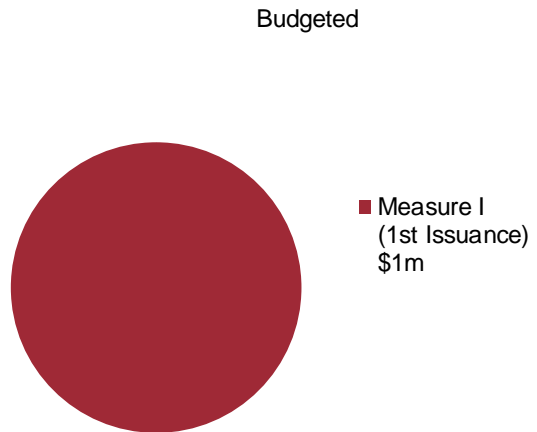



Jackson Elementary School

1143 Nakoma Dr. Santa Ana, CA 92704

Preschool Lab Classrooms & New Playground

Project Description

Jackson was built in 1962 and also has a new classroom building built in 2009. This project will convert one of the older classroom wings into preschool classrooms. New Kindergarten and Preschool playgrounds will also be added.

Architect:	Lionakis Architecture
DSA Status:	Pending Submittal by end of 2019
Project Status:	Planning/Design
Measure I Budget:	\$1,100,507
Total Budget:	\$1,100,507

Status Summary

A conceptual layout of the classrooms was prepared by the architect in fall 2019. A landscape architect has developed playground concepts and received District feedback in October 2019. Construction drawings are anticipated in November 2019.



Jackson Elementary School

1143 Nakoma Dr. Santa Ana, CA 92704

Preschool Lab Classrooms & New Playground

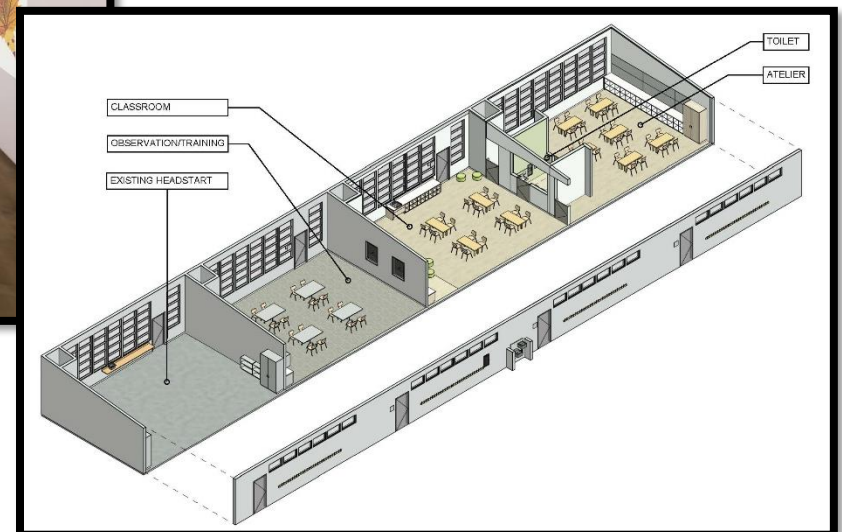



Jackson Elementary School

1143 Nakoma Dr. Santa Ana, CA 92704

Preschool Lab Classrooms & New Playground

Summary Status

Description	Budgeted	Committed	Expended
Site Cost	-	-	-
Soft Cost	248,775	140,775	17,320
Hard Cost	820,000	-	-
Contingency	31,732	-	-
Total	1,100,507	140,775	17,320

Budgeted Hard Cost 74.5%

Budget Status

Initial Amount	1,100,507
Pending Changes	-
Total	1,100,507

Budgeted Contingency 2.9%

Committed Status

Initial Contracted AMT	140,775
Total	140,775

Budget Committed 12.8%

Expenditure Status

In Process for PMT	17,320
Total	17,320

Budget Expended 1.6%

Progress

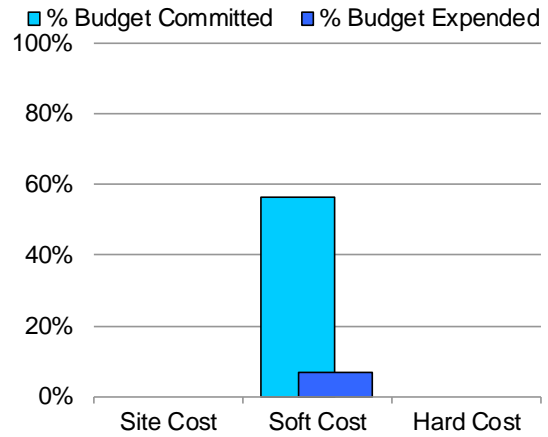

Funding Sources

Budgeted

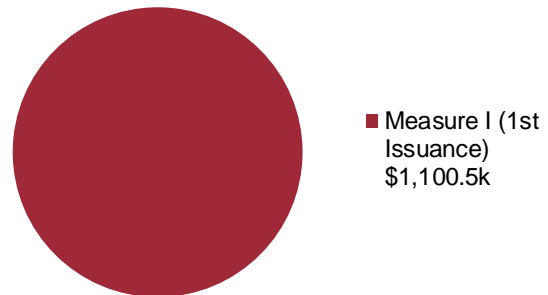



District Wide

Various sites

Single Point of Entry/ Fencing/ Security Cameras

Project Description

In March 2018, Facilities Planning, with input from SAUSD Police, published the District's Safety and Security Report and Plan of Action. Subsequently, staff engaged an architect to begin designing biddable drawings for Single Point of Entry, Fencing and Security Camera improvements.

Architect:	Morrissey Associates, Inc.
DSA Status:	Pending
Project Status:	Design/Planning
Measure I Budget:	\$3,336,336 (Phase I)
Total Budget:	\$3,714,336 (Phase I) \$11,143,008 (Phases II, III, IV)

Status Summary

Staff and the architect have developed schematic design drawing for the first 21 schools under analysis and have reviewed with site administration. Meetings were held in September and October 2019 to review recommended security camera locations and draft specifications. Concurrently, Architects are proceeding with the remaining 40 school sites to be completed in phases.



District Wide

Various sites

Single Point of Entry/ Fencing/ Security Cameras

Sample drawings:

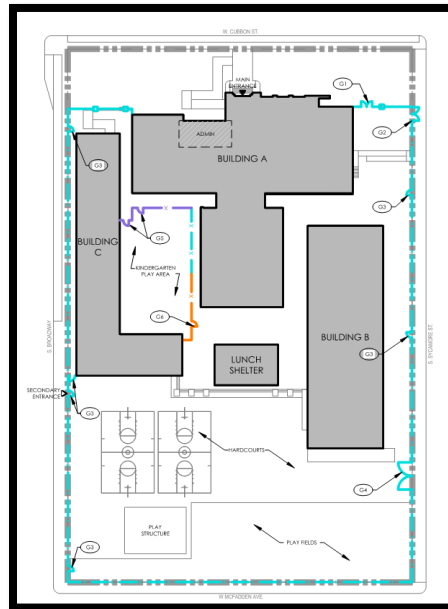

SITE FENCING
RECOMMENDATION PLAN

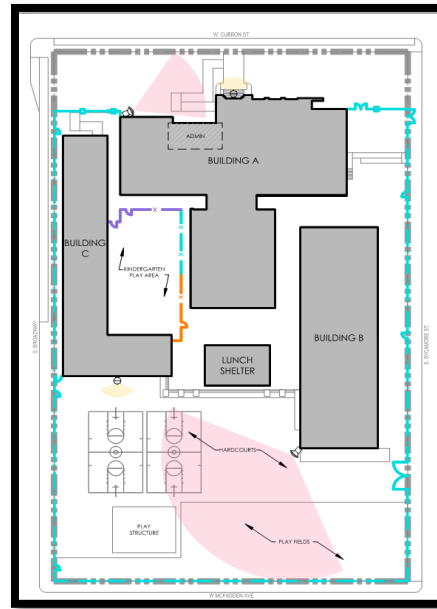

SITE LIGHTING AND CAMERA
RECOMMENDATION PLAN

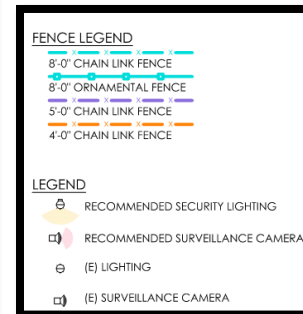

Phase I sites:

1. Carver Elementary
2. Franklin Elementary
3. Fremont Elementary
4. Garfield Elementary
5. Harvey Elementary
6. ML King Elementary
7. Pio Pico Elementary
8. Santiago K-8
9. Taft Elementary
10. Walker Elementary
11. Washington Elementary
12. Wilson Elementary
13. McFadden Intermediate
14. Romero-Cruz Academy
15. Chavez High
16. Century High
17. Godinez High
18. Saddleback High
19. Santa Ana High
20. Segerstrom High
21. Advanced Learning Academy I



District Wide

Various sites

Single Point of Entry/ Fencing/ Security Cameras (Phase I)

Summary Status

Description	Budgeted	Committed	Expended
Site Cost	-	-	-
Soft Cost	511,632	378,000	262,450
Hard Cost	3,080,000	-	-
Contingency	122,704	-	-
Total	3,714,336	378,000	262,450
Budgeted Hard Cost 82.9%			

Budget Status

Initial Amount	3,714,336
Pending Changes	-
Total	3,714,336
Budgeted Contingency 3.3%	

Committed Status

Initial Contracted AMT	364,000	
Contract Changes	14,000	3.7%
Total	378,000	
Budget Committed 10.2%		

Expenditure Status

Paid	262,030
In Process for PMT	420
Total	262,450
Budget Expended 7.1%	

Progress

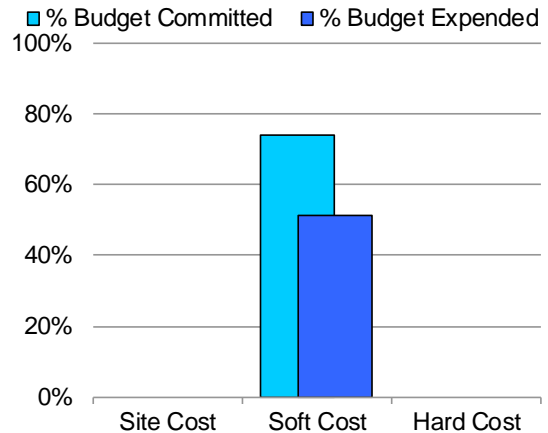

Funding Sources

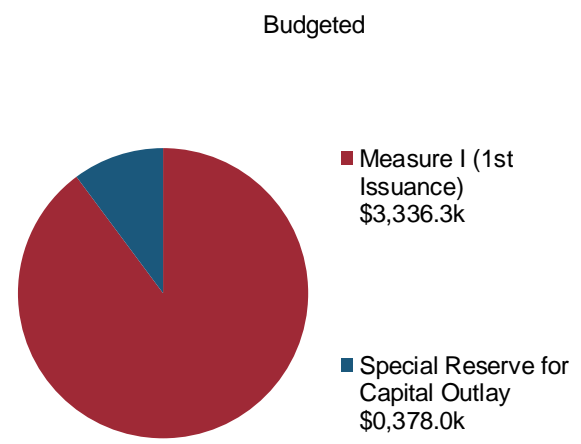



District Wide

Various sites

Single Point of Entry/ Fencing/ Security Cameras (Phases II, III, IV)

Summary Status

Description	Budgeted	Committed	Expended
Site Cost	-	-	-
Soft Cost	1,620,000	-	-
Hard Cost	9,240,000	-	-
Contingency	283,008	-	-
Total	11,143,008	-	-
Budgeted Hard Cost 82.9%			

Budget Status

Initial Amount	11,143,008
Pending Changes	-
Total	11,143,008
Budgeted Contingency 2.5%	

Committed Status

No Commitments to report.

Expended Status

No Expenditures to report.

Progress

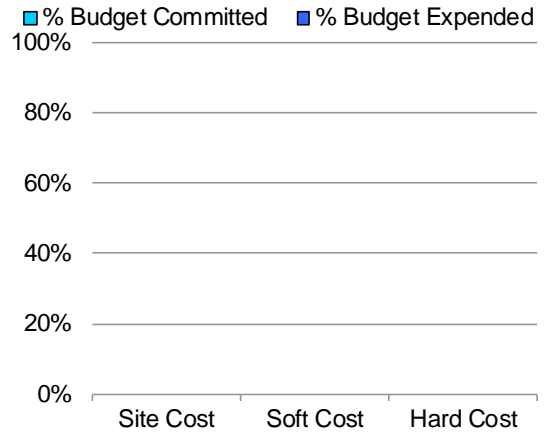

Funding Sources

Budgeted

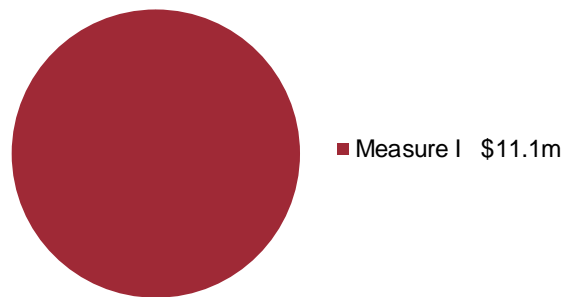



Valley High School

1801 S. Greenville St. Santa Ana, CA 92704

CTE Culinary Arts Building

Project Description

This project will provide an innovative and agile learning space to increase the capacity of the Culinary Arts & Hospitality Academy (CHA) and construct a modern space for food preparation, instruction and serving.

Architect:	Baker Nowicki (proposed)
Construction Manager:	(pending)
DSA Status:	Pending Submittal
Project Status:	Pending Architect Approval
Measure I Budget:	\$3,000,000
Total Budget:	\$6,000,000

Status Summary

In fall 2018, staff prepared an application for the State's Career Technical Education Facilities Grant Program. The grant received a high score and was ultimately funded by the State in May 2019, which provides a \$3,000,000 State grant to the District. An architectural proposal is pending.



Valley High School

1801 S. Greenville St. Santa Ana, CA 92704

CTE Culinary Arts Building

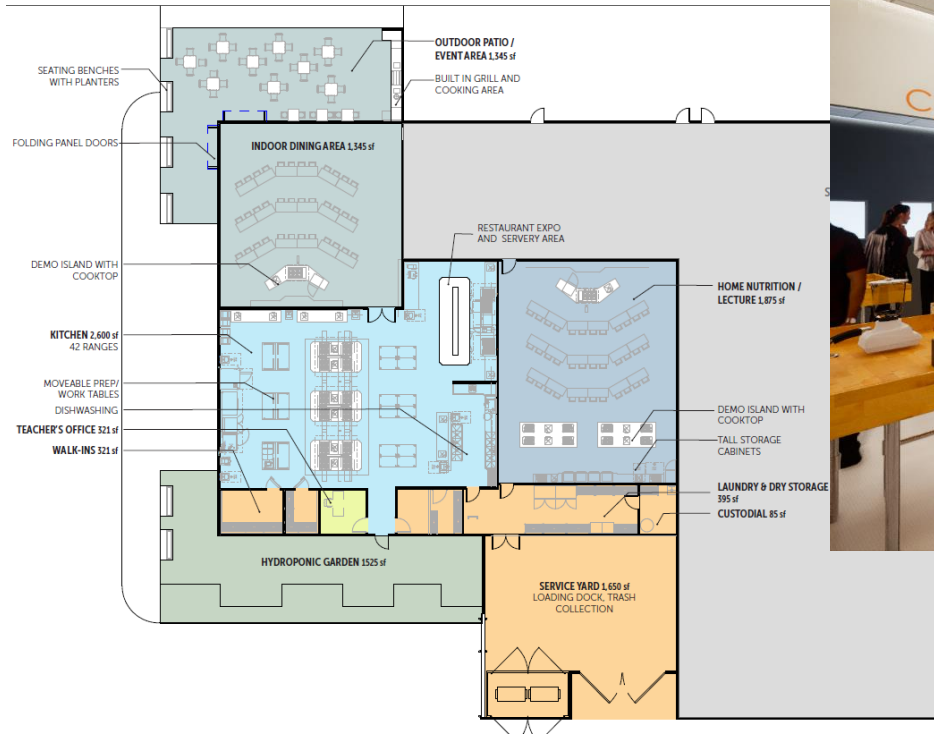



Valley High School

1801 S. Greenville St. Santa Ana, CA 92704

CTE Culinary Arts Building

Summary Status

Description	Budgeted	Committed	Expended
Site Cost	-	-	-
Soft Cost	994,500	-	-
Hard Cost	4,095,000	-	-
Contingency	910,500	-	-
Total	6,000,000	-	-
Budgeted Hard Cost 68.3%			

Budget Status

Initial Amount	6,000,000
Pending Changes	-
Total	6,000,000
Budgeted Contingency 15.2%	

Committed Status

No Commitments to report.

Expended Status

No Expenditures to report.

Progress

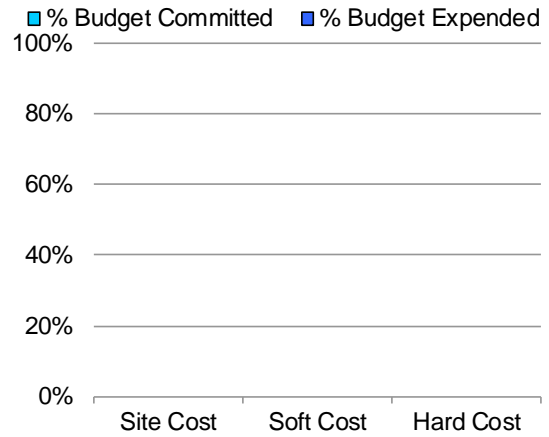

Funding Sources

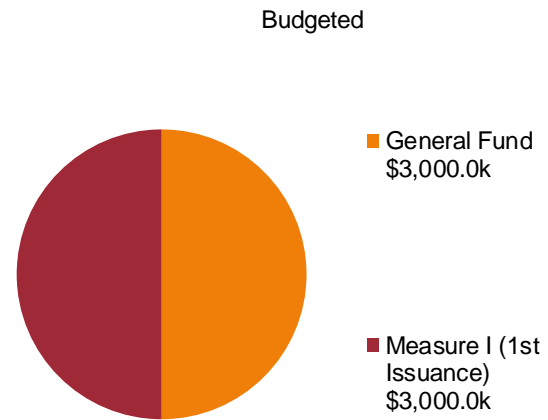



Washington Elementary School

910 W. Anahurst Pl. Santa Ana, CA 92707

Reconstruction

Project Description

Portions of Washington were built 70 years ago in 1949. This project will reorient the campus by centralizing school buildings adjacent to the P2P building by constructing a new Administration, Multipurpose Room, Kindergarten wing, new parking lot/drop-off, expand playfields, and new playgrounds as well as repurpose the original wings for Early Childhood Education (preschool) classrooms and wellness center for community use.

Architect:	LPA (Proposed)
Construction Manager:	Tilden Coil (Proposed)
DSA Status:	N/A
Project Status:	Pending Architect Approval
Measure I Budget:	\$13,850,963
Project Budget:	\$19,042,455, pending Board approval

Status Summary

Initial architectural work for modernization is complete. An architectural proposal is pending. Once approved by the Board, design will proceed and programming meetings with site representatives will be held to discuss conceptual design of campus improvements. If Proposition 13 is approved by California voters in March 2020, the project may become eligible for a significant increase in State funding toward replacement of 70-year-old facilities.



Washington Elementary School

910 W. Anahurst Pl. Santa Ana, CA 92707

Reconstruction



SCOPE OF WORK LEGEND:

- EXISTING BUILDING - NO WORK PROPOSED
- EXISTING BUILDING - MINOR MODERNIZATION
- EXISTING BUILDING - MAJOR MODERNIZATION
- NEW CONSTRUCTION
- NEW COVERED SHELTER
- NEW OR RENOVATED FIELD / LANDSCAPING
- NEW ASPHALT PAVEMENT
- NEW HARDSCAPE PAVING
- NEW SITE FENCING

Year Built	1949
Year Last Modernized	2012
Site Acreage	8.18
Existing Permanent Buildings	92,471
Existing Portables	0
Current Site Capacity	1,450
Current Enrollment (16/17)	823



Washington Elementary School

910 W. Anahurst Pl. Santa Ana, CA 92707

Reconstruction

Summary Status

Description	Budgeted	Committed	Expended
Site Cost	-	-	-
Soft Cost	2,426,725	1,476,746	766,623
Hard Cost	14,750,000	-	-
Contingency	1,865,730	-	-
Total	19,042,455	1,476,746	766,623
Budgeted Hard Cost 77.5%			

Budget Status

Initial Amount	19,042,455
Pending Changes	-
Total	19,042,455
Budgeted Contingency 9.8%	

Committed Status

Initial Contracted AMT	978,885
Contract Changes	497,861 33.7%
Total	1,476,746
Budget Committed 7.8%	

Expenditure Status

Paid	759,862
In Process for PMT	2,852
District Held Retentions	3,909
Total	766,623
Budget Expended 4.0%	

Progress

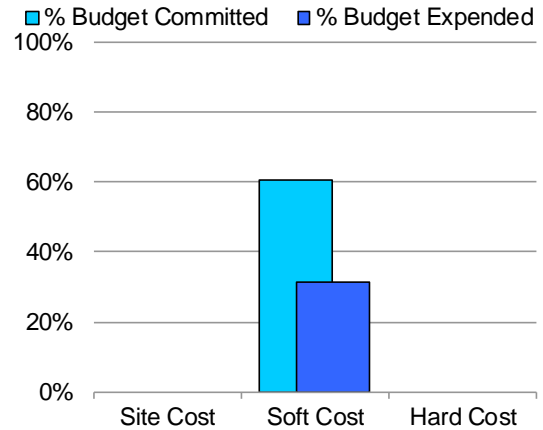

Funding Sources

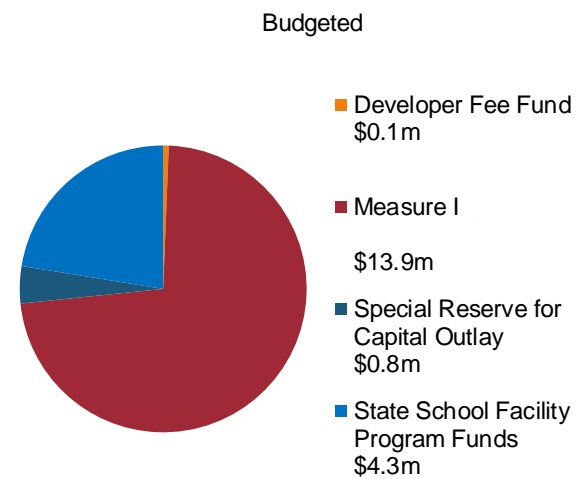



Saddleback High School

2802 S. Flower St. Santa Ana, CA 92707

Sports Complex

Project Description

Saddleback High school was built in 1966 without sports facilities equitable to other comprehensive high schools. This project establishes a stadium and support buildings for school and community use.

Architect:	Ruhnau Clark (proposed)
Construction Manager:	(pending)
DSA Status:	Pending Architect Approval
Project Status:	Planning
Measure I Budget:	\$13,311,053
Project Budget:	\$14,311,053

Status Summary

In 2019, District and site staff began planning based on the 2018 Facilities Master Plan. Upon receipt of an architectural proposal, the District will begin schematic design. On September 21, 2019, an informational meeting was held with parents and community members to gather feedback on the proposed approach.



Saddleback High School

2802 S. Flower St. Santa Ana, CA 92707

Sports Complex





Saddleback High School

2802 S. Flower St. Santa Ana, CA 92707

Sports Complex

Summary Status

Description	Budgeted	Committed	Expended
Site Cost	-	-	-
Soft Cost	2,467,678	-	-
Hard Cost	8,693,965	-	-
Contingency	3,149,410	-	-
Total	14,311,053	-	-
Budgeted Hard Cost 60.8%			

Budget Status

Initial Amount	14,311,053
Pending Changes	-
Total	14,311,053
Budgeted Contingency 22.0%	

Committed Status

No Commitments to report.

Expended Status

No Expenditures to report.

Progress

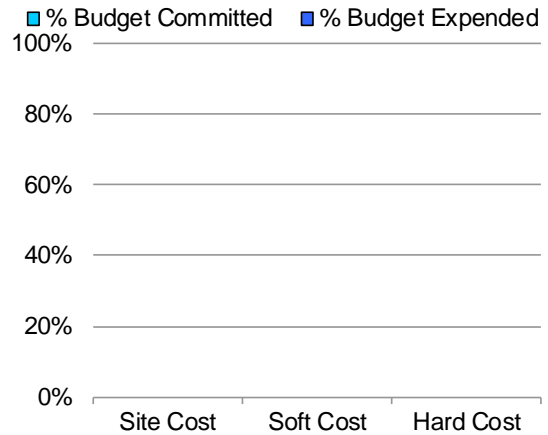

Funding Sources

Budgeted

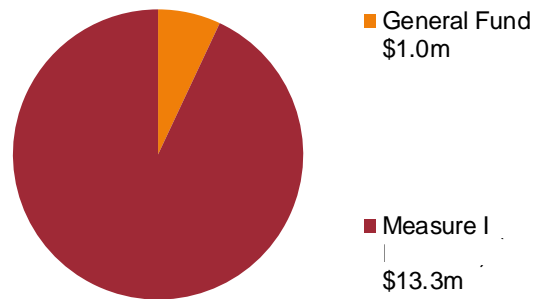



Valley High School

1801 S. Greenville St. Santa Ana, CA 92704

Auditorium Renovation

Project Description

The auditorium at Valley High School was built in 1959 and has had minimal improvement since that time. This project will provide modern interiors and attractive exteriors such as restroom modernization, rigging system and stage floor replacement, Americans with Disabilities Act (ADA) compliance, technology replacement, LED stage lighting, HVAC upgrade, seat replacement, Greenroom renovation, and sitework and landscaping improvements. The completed project will provide a modern school and community resource for the performing arts.

Architect:	Baker Nowicki (proposed)
Construction Manager:	(pending)
DSA Status:	Pending Submittal
Project Status:	Pending Architect Approval
Measure I Budget:	\$19,322,260
Total Budget:	\$19,322,260

Status Summary

An assessment of existing conditions and initial design of improvements began in October 2019. Teachers and site staff have been consulted as to needed improvements in order to refine the project's scope of work.



Valley High School

1801 S. Greenville St. Santa Ana, CA 92704

Auditorium Renovation

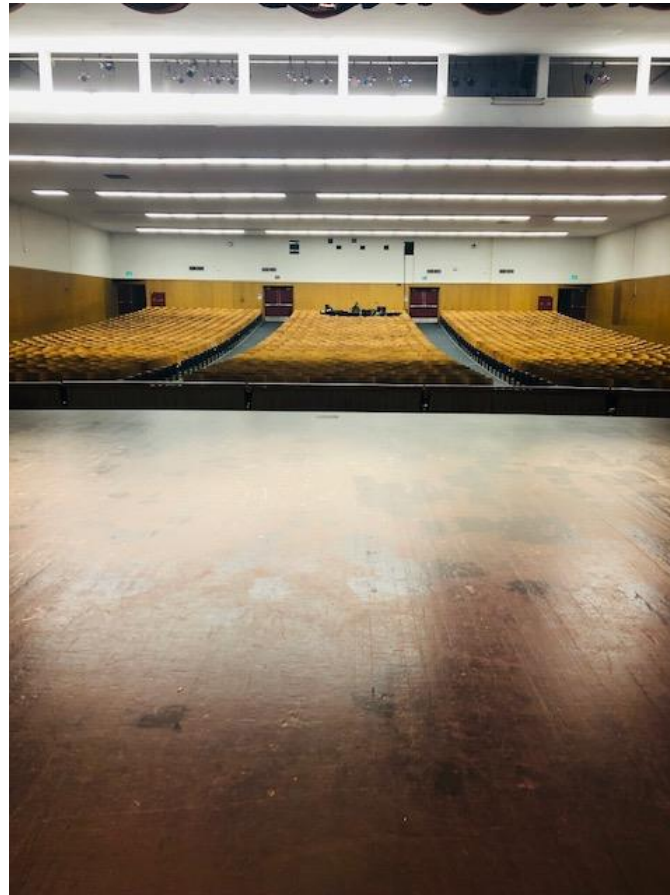

EXISTING
AUDITORIUM



Valley High School

1801 S. Greenville St. Santa Ana, CA 92704

Auditorium Renovation

Summary Status

Description	Budgeted	Committed	Expended
Site Cost	-	-	-
Soft Cost	3,956,233	-	-
Hard Cost	13,187,442	-	-
Contingency	2,178,585	-	-
Total	19,322,260	-	-
Budgeted Hard Cost 68.3%			

Budget Status

Initial Amount	19,322,260
Pending Changes	-
Total	19,322,260
Budgeted Contingency 11.3%	

Committed Status

No Commitments to report.

Expended Status

No Expenditures to report.

Progress

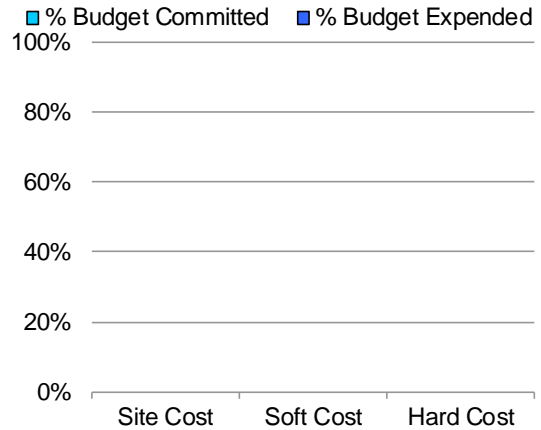

Funding Sources

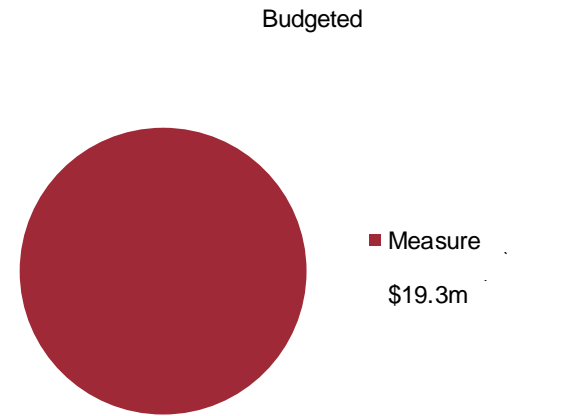



Jefferson Elementary School

1522 W. Adams St. Santa Ana, CA 92704

Portable to Permanent (P2P)

Project Description

Jefferson Elementary was built in 1965 and contains 12 portable classrooms that have been added over the years to address capacity needs. The project replaces portables with a permanent 2-story building, provides full sized kindergarten classrooms, improves parking, and adds a multipurpose room for school and community use.

Architect:	Morrissey Associates, Inc. (proposed)
Construction Manager:	(pending)
DSA Status:	Pending Design
Project Status:	Planning
Measure I Budget:	\$24,144,577
Total Budget:	\$24,144,577, pending Board approval

Status Summary

An assessment of existing conditions and initial design of improvements began in October 2019. Teachers and site staff have been consulted regarding improvements in order to refine the project's scope of work.



Jefferson Elementary School

1522 W. Adams St. Santa Ana, CA 92704

Portable to Permanent (P2P)

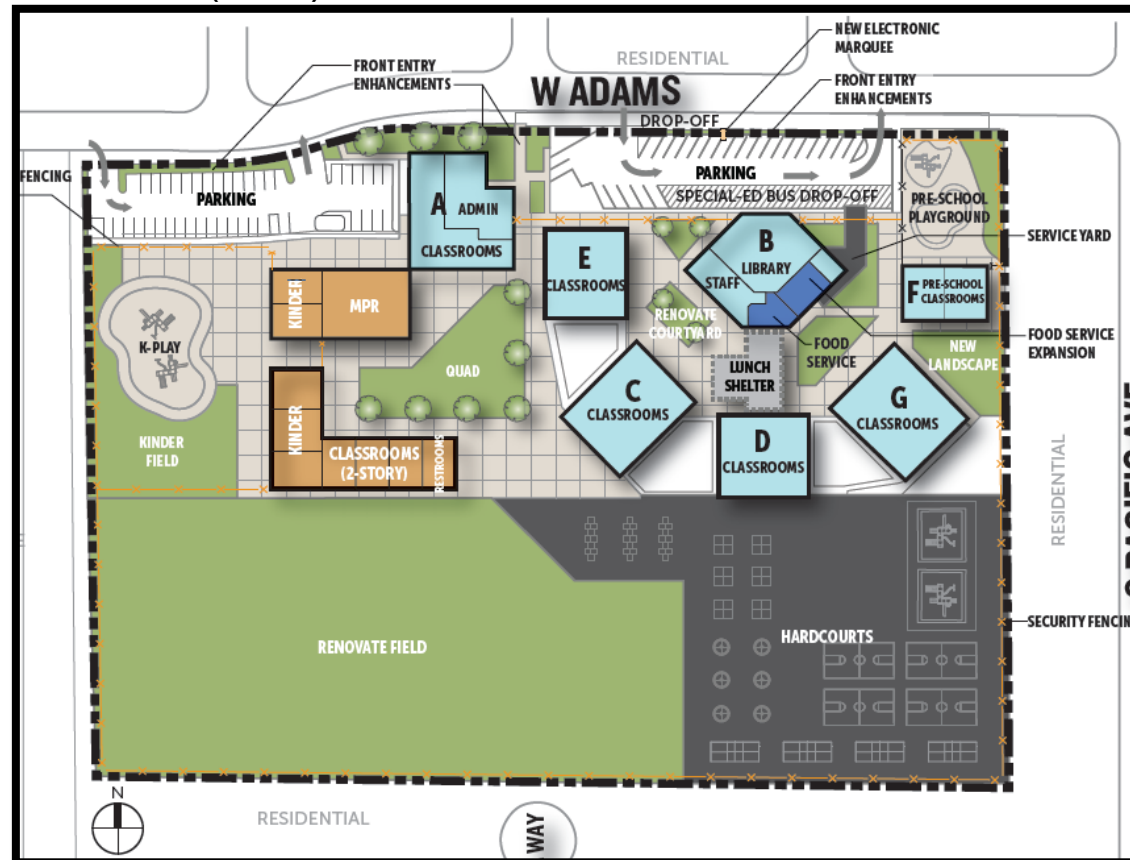



Jefferson Elementary School

1522 W. Adams St. Santa Ana, CA 92704

Portable to Permanent (P2P)

Summary Status

Description	Budgeted	Committed	Expended
Site Cost	-	-	-
Soft Cost	5,632,830	-	-
Hard Cost	14,000,000	-	-
Contingency	4,511,747	-	-
Total	24,144,577	-	-

Budgeted Hard Cost 58.0%

Budget Status

Initial Amount	24,144,577
Pending Changes	-
Total	24,144,577

Budgeted Contingency 18.7%

Committed Status

No Commitments to report.

Expended Status

No Expenditures to report.

Progress

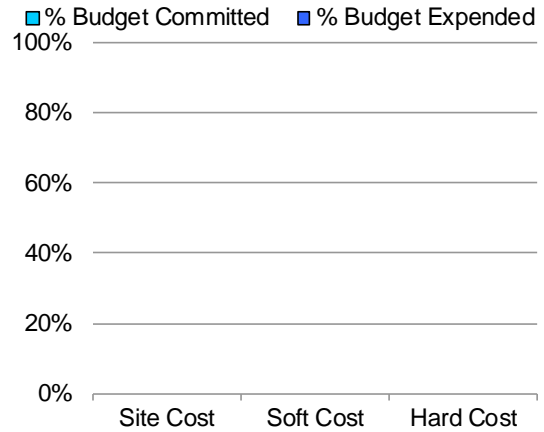

Funding Sources

Budgeted

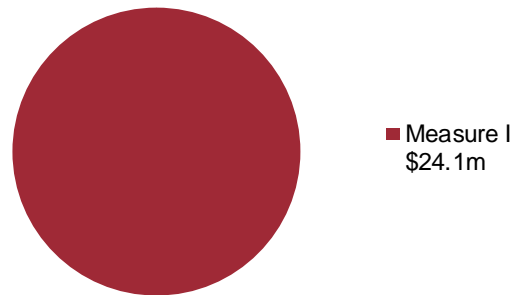



Advanced Learning Academy/ Edward B. Cole

335 E. Walnut St., Santa Ana, CA 92701

Single Point of Entry and New Kitchen Building

Project Description

The Advanced Learning Academy does not have an office with access from outside the school grounds, currently requiring visitors to enter the campus before reaching the front office. To solve this challenge and improve site safety, a new office facility will be established at the Maple Street entrance. Additionally, to improve service to students of both sites, a new kitchen building will be constructed with shared access.

Architect:	Ghataode Bannon Architects
Construction Manager:	(pending)
DSA Status:	Approved
Project Status:	Pending Bidding
Measure I Budget:	\$2,716,000
Total Budget:	\$2,861,340

Status Summary

The project was State approved in spring of 2019. During the summer of 2019, the site was extensively mapped by an underground survey company to identify all existing utility locations in preparation for construction. The survey will produce a set of utility drawings for bidding purposes. Bidding will proceed pending receipt of State reimbursement funds on other District projects.



Advanced Learning Academy/ Edward B. Cole

335 E. Walnut St., Santa Ana, CA 92701

Single Point of Entry and New Kitchen Building

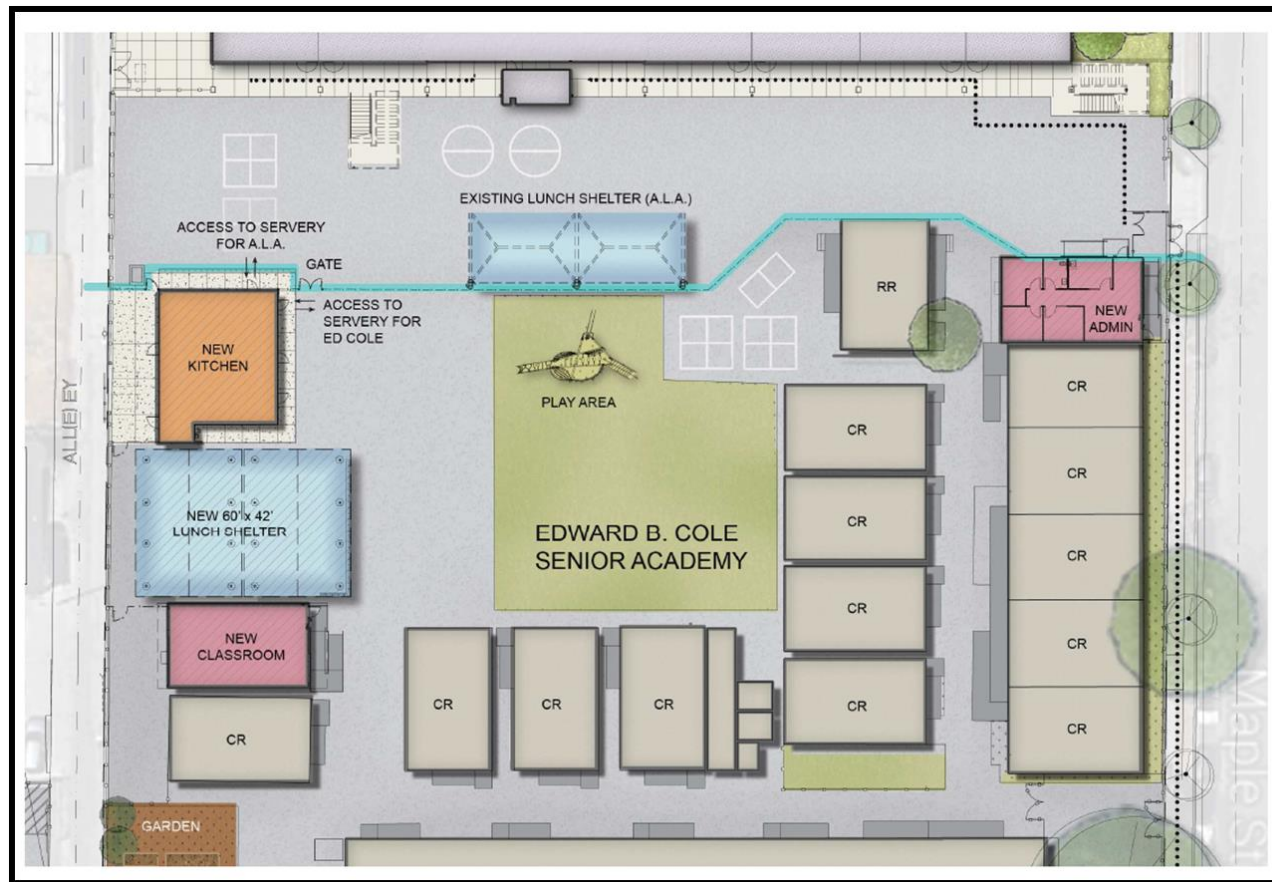



Advanced Learning Academy/ Edward B. Cole

335 E. Walnut St., Santa Ana, CA 92701

Single Point of Entry and New Kitchen Building

Summary Status

Description	Budgeted	Committed	Expended
Site Cost	-	-	-
Soft Cost	585,859	145,050	92,324
Hard Cost	1,952,865	-	-
Contingency	322,616	-	-
Total	2,861,340	145,050	92,324

Budgeted Hard Cost 68.3%

Budget Status

Initial Amount	2,861,340
Pending Changes	-
Total	2,861,340

Budgeted Contingency 11.3%

Committed Status

Initial Contracted AMT	145,050
Contract Changes	- 0.0%
Total	145,050

Budget Committed 5.1%

Expenditure Status

Paid	92,324
Total	92,324

Budget Expended 3.2%

Progress

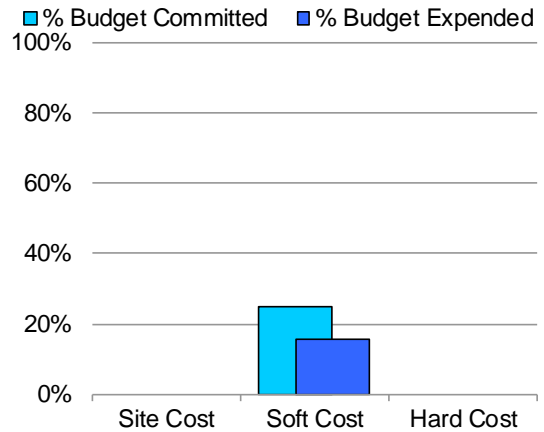

Funding Sources

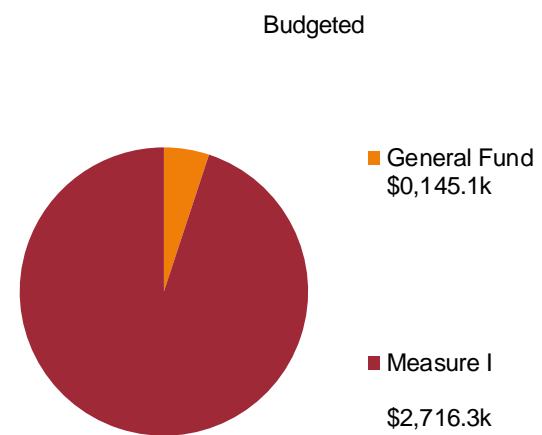



Century High School

1401 S. Grand Ave., Santa Ana, CA 92705

Modernization

Project Description

Century High School was originally built in 1989. The planned Modernization project provides general renovation of the school's facilities, including a modern library, maker space, Americans with Disabilities Act (ADA) accessible restrooms, kitchen improvements, and a new office and counseling center.

Architect:	HMC Architects
Construction Manager:	Ledesma & Meyer Construction Co., Inc.
DSA Status:	Approved
Project Status:	Pending State Bond Funds
Measure I Budget:	\$5,849,163
Total Budget:	\$19,771,429

Status Summary

The project was State approved in late 2018 and is currently pending State matching funds which are anticipated in 2020 or thereafter. Once funds are announced, the District will begin bidding and preparation for construction.



Century High School

1401 S. Grand Ave., Santa Ana, CA 92705

Modernization

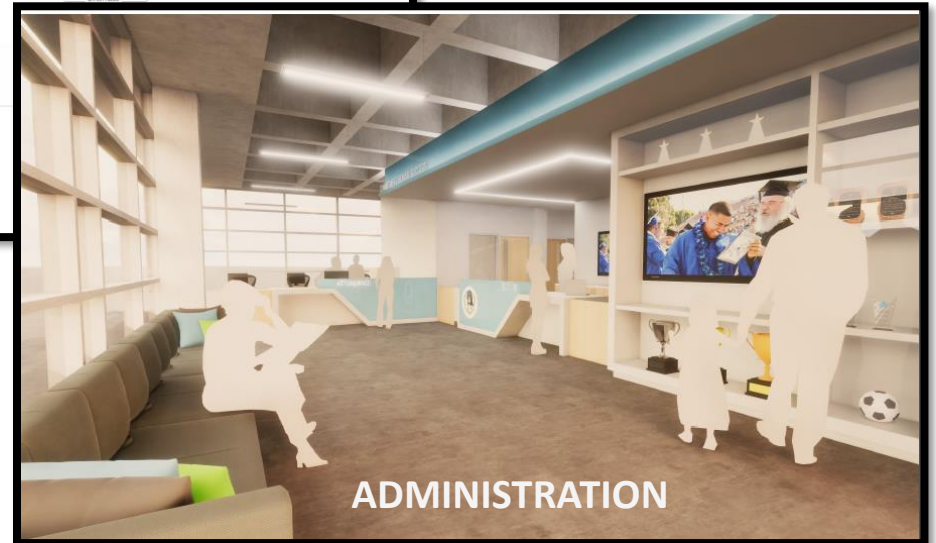
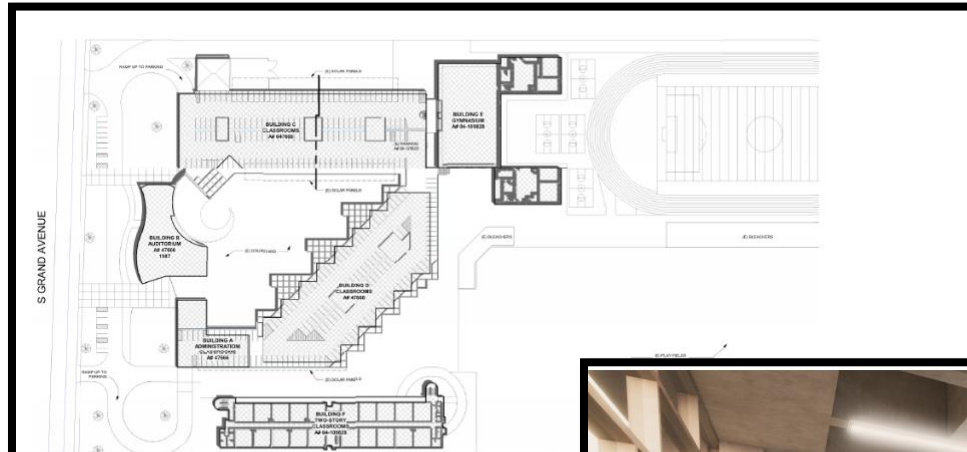



Century High School

1401 S. Grand Ave., Santa Ana, CA 92705

Modernization

Summary Status

Description	Budgeted	Committed	Expended
Site Cost	-	-	-
Soft Cost	4,162,378	2,059,409	1,532,272
Hard Cost	9,079,615	-	-
Contingency	6,529,437	-	-
Total	19,771,429	2,059,409	1,532,272
Budgeted Hard Cost 45.9%			

Budget Status

Initial Amount	19,771,429
Pending Changes	-
Total	19,771,429
Budgeted Contingency 33.0%	

Committed Status

Initial Contracted AMT	1,060,450
Contract Changes	998,959 48.5%
Total	2,059,409
Budget Committed 10.4%	

Expenditure Status

Paid	1,532,272
Total	1,532,272
Budget Expended 7.7%	

Progress

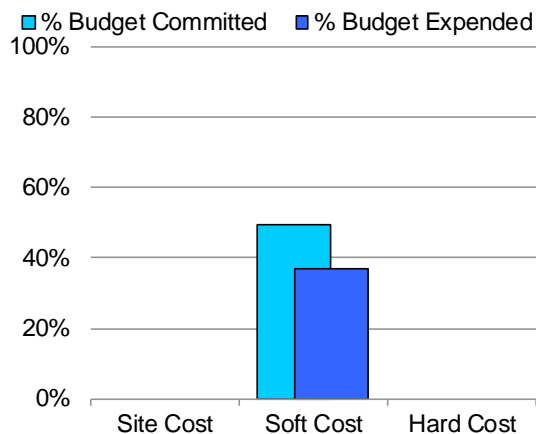

Funding Sources

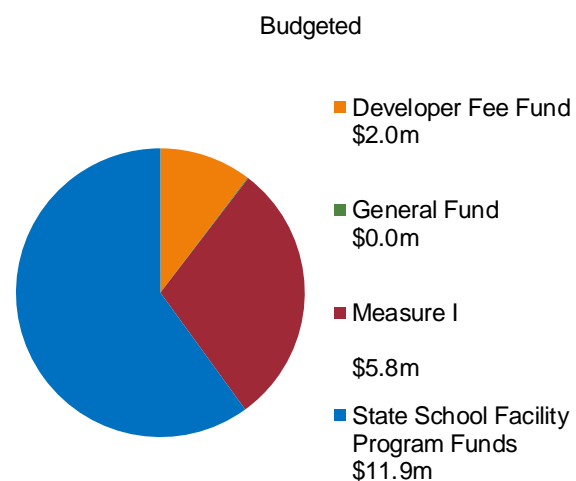



Santa Ana High School

520 W. Walnut St. Santa Ana, CA 92701

Modernization

Project Description

Santa Ana High School was originally built in 1935. The project provides general modernization of the school's facilities, including a new attendance office and secure campus entry, new dance and music classrooms, new ADA accessible restrooms, and a new health office and wellness center.

Architect:	HMC Architects
Construction Manager:	Ledesma & Meyer Construction Co., Inc.
DSA Status:	Approved
Bidding & Award:	Pending State Bond Funds
Measure I Budget	\$6,332,480
Project Budget:	\$21,000,000

Status Summary

The project was State approved in late 2018 and is currently pending State matching funds which are anticipated in 2020 or thereafter. Once funds are allocated by the State Allocation Board, the District will begin bidding and preparation for construction.



Santa Ana High School

520 W. Walnut St. Santa Ana, CA 92701

Modernization

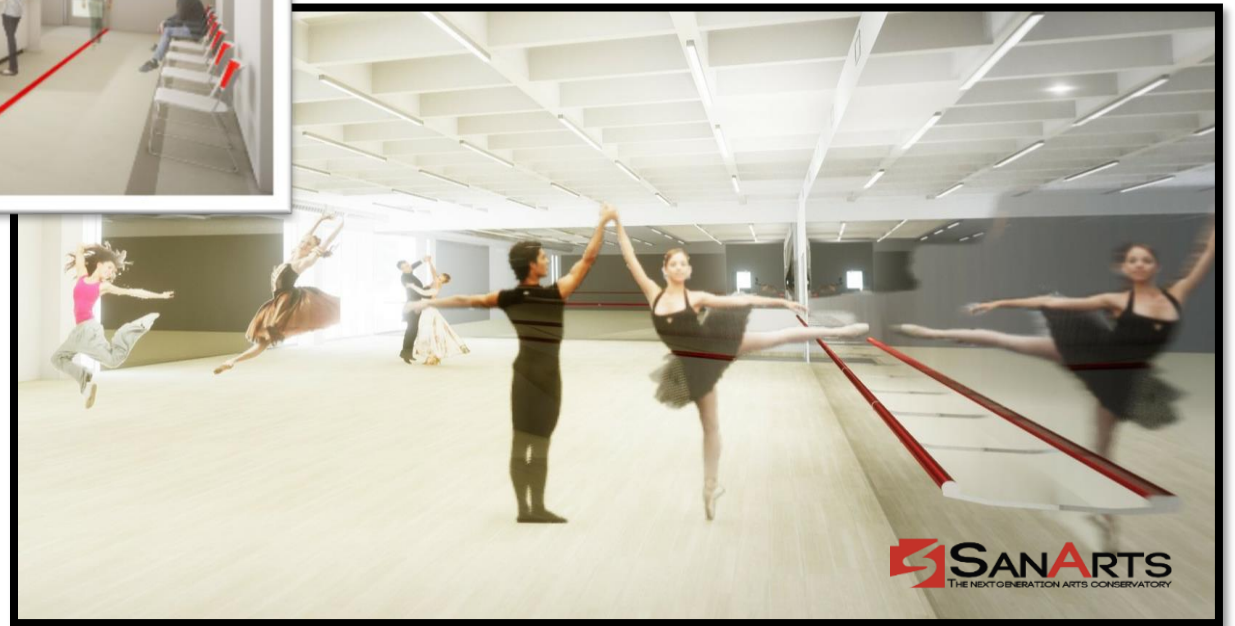
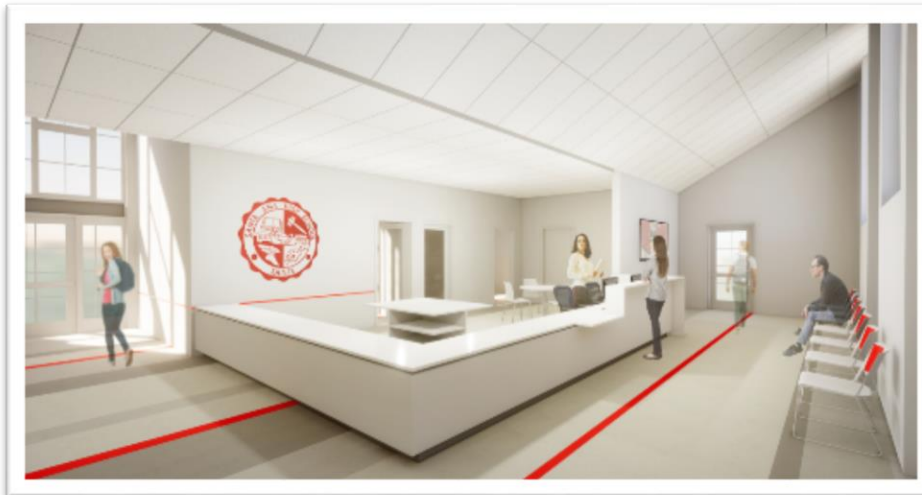



Santa Ana High School

520 W. Walnut St. Santa Ana, CA 92701

Modernization

Summary Status

Description	Budgeted	Committed	Expended
Site Cost	-	-	-
Soft Cost	3,969,880	2,140,495	1,571,853
Hard Cost	16,374,458	-	-
Contingency	655,662	-	-
Total	21,000,000	2,140,495	1,571,853

Budgeted Hard Cost 78.0%

Budget Status

Initial Amount	21,000,000
Pending Changes	-
Total	21,000,000

Budgeted Contingency 3.1%

Committed Status

Initial Contracted AMT	690,745
Contract Changes	1,449,750 67.7%
Total	2,140,495

Budget Committed 10.2%

Expenditure Status

Paid	1,571,853
Total	1,571,853

Budget Expended 7.5%

Progress

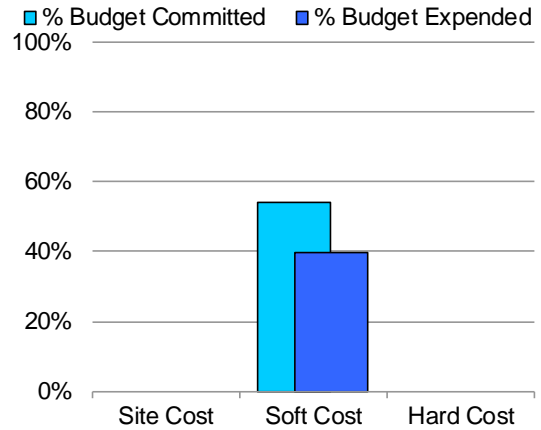

Funding Sources

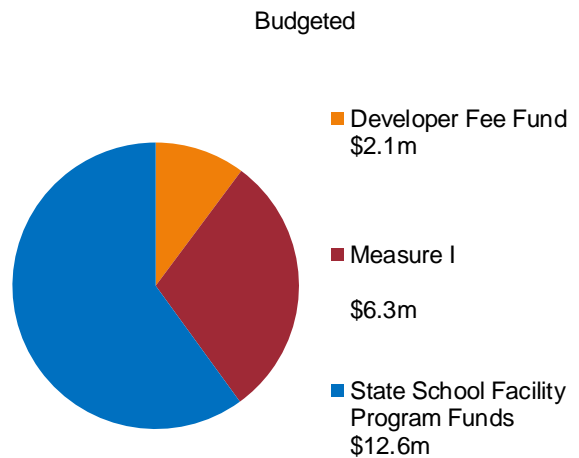



Chavez High School

2128 S. Cypress Ave., Santa Ana, CA 92707

Modernization

Project Description

Chavez High School was originally built in 1991. The site has 12 classrooms. Modernization will address dated infrastructure and Americans with Disabilities Act (ADA) accessibility.

Architect:	SVA Architects
DSA Status:	Approved
Project Status:	Pending State Bond Funds
Measure I Budget	\$692,144
Total Budget:	\$2,239,954

Status Summary

The project was State approved in early 2019 and is currently pending State matching funds which are anticipated in 2020 or thereafter. Once funds are allocated by the State Allocation Board, the District will begin bidding and preparation for construction.



Chavez High School

2128 S. Cypress Ave., Santa Ana, CA 92707

Modernization

	RESTROOM IMPROVEMENTS
	HARDSCAPE IMPROVEMENTS
	LANDSCAPE IMPROVEMENTS

EXISTING ELEVATION PROPOSED ELEVATION

WEST FRONT ELEVATION

EAST REAR ELEVATION

OWNER: SANTA ANA UNIFIED SCHOOL DISTRICT
 PROJECT NAME: CESAR E. CHAVEZ HIGH SCHOOL MODERNIZATION
 2128 S. CYPRESS AVE., SANTA ANA, CA 92707

IDENTIFY CAPITAL LEADERS
 DIVISION OF THE STATE ARCHITECT
 OFFICE OF REGULATION & LICENSING
 ABO4-117454
 NC FLA SS
 DATE: _____

REVISIONS	DESCRIPTION	DATE

DATE REVISION: 11/26/2019
 PROJECT NO.: 2018-0114
 SCALE: As Shown

SHEET NUMBER: **A01.5**
 SHEET TITLE: **OVERALL SITE PLAN**

RESTROOM IMPROVEMENTS
 HARDSCAPE IMPROVEMENTS
 LANDSCAPE IMPROVEMENTS

AREA OF WORK
 EXISTING IMPROVEMENTS
 ACCESSIBLE PARKING SPACES
 ACCESSIBLE DRIVEWAY
 (NO) SIGNAGE
 (NO) SIGNAGE

GENERAL NOTES

- REFER TO OTHER SHEETS FOR ALL SIZES AND ELEVATIONS.
- REFER TO CIVIL DRAWINGS FOR FULL EXTENT OF SITE WORK.
- REFER TO LANDSCAPE DRAWINGS FOR FULL EXTENT OF SITE WORK.
- WHERE FIRE LINES OCCUR, REFER TO DETAIL UNLESS SHOWN OTHERWISE.

OVERALL SITE PLAN 11/26/2019

KEY PLAN



Chavez High School

2128 S. Cypress Ave., Santa Ana, CA 92707

Modernization

Summary Status

Description	Budgeted	Committed	Expended
Site Cost	-	-	-
Soft Cost	416,718	209,242	165,458
Hard Cost	1,528,769	-	-
Contingency	294,468	-	-
Total	2,239,954	209,242	165,458

Budgeted Hard Cost 68.2%

Budget Status

Initial Amount	2,239,954
Pending Changes	-
Total	2,239,954

Budgeted Contingency 13.1%

Committed Status

Initial Contracted AMT	221,800	
Contract Changes	(12,558)	-6.0%
Total	209,242	

Budget Committed 9.3%

Expenditure Status

Paid	165,458
Total	165,458

Budget Expended 7.4%

Progress

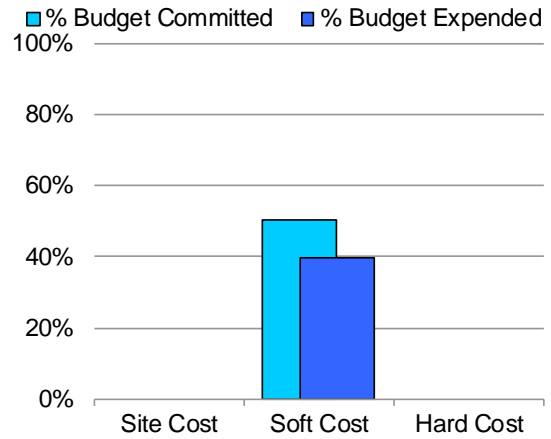

Funding Sources

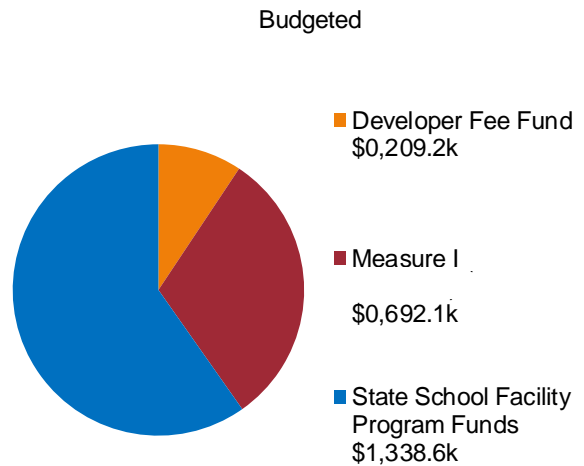



Davis Elementary School

1405 French St. Santa Ana, CA 92701

Modernization

Project Description

Davis Elementary School was originally built in 1957. The site has 33 classrooms. Modernization will address dated infrastructure and Americans with Disabilities Act (ADA) accessibility.

Architect:	SVA Architects
DSA Status:	Approved
Project Status:	Pending State Bond Funds
Measure I Budget:	\$1,797,767
Total Budget:	\$5,647,960

Status Summary

The project was State approved in early 2019 and is currently pending State matching funds which are anticipated in 2020 or thereafter. Once funds are allocated by the State Allocation Board, the District will begin bidding and preparation for construction.



Davis Elementary School

1405 French St. Santa Ana, CA 92701

Modernization

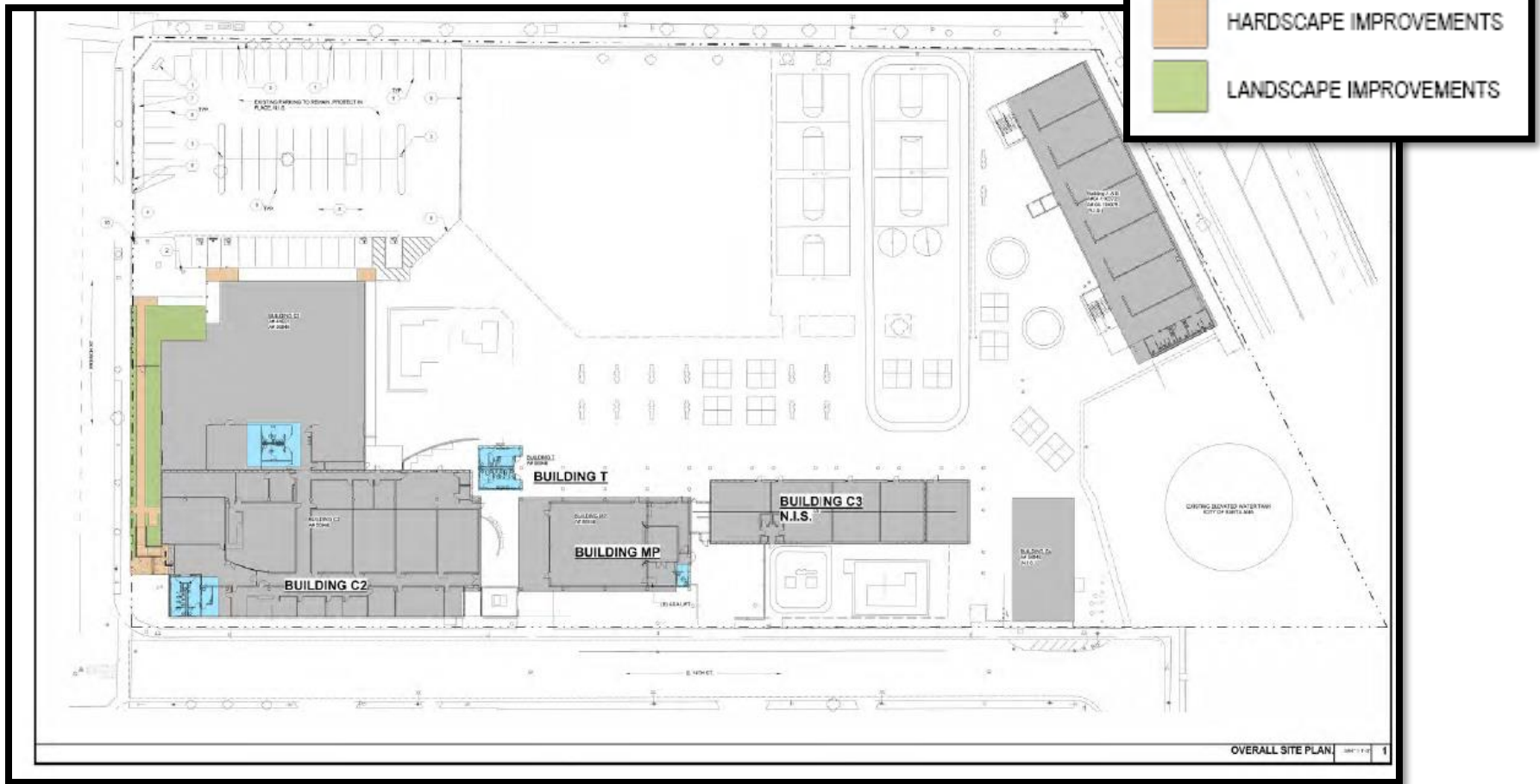



Davis Elementary School

1405 French St. Santa Ana, CA 92701

Modernization

Summary Status

Description	Budgeted	Committed	Expended
Site Cost	-	-	-
Soft Cost	986,299	461,417	358,325
Hard Cost	3,854,733	-	-
Contingency	806,928	-	-
Total	5,647,960	461,417	358,325

Budgeted Hard Cost 68.3%

Budget Status

Initial Amount	5,647,960
Pending Changes	-
Total	5,647,960

Budgeted Contingency 14.3%

Committed Status

Initial Contracted AMT	281,767	
Contract Changes	179,650	38.9%
Total	461,417	

Budget Committed 8.2%

Expenditure Status

Paid	358,325
Total	358,325

Budget Expended 6.3%

Progress

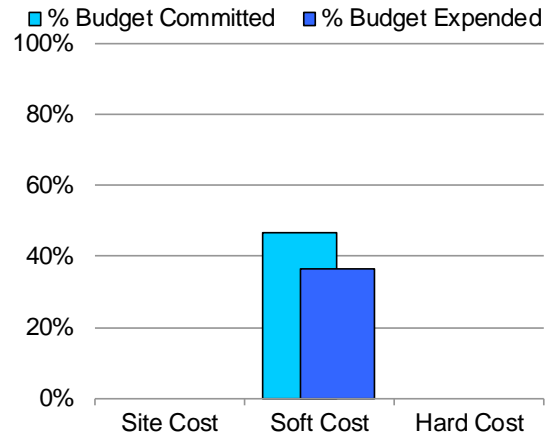

Funding Sources

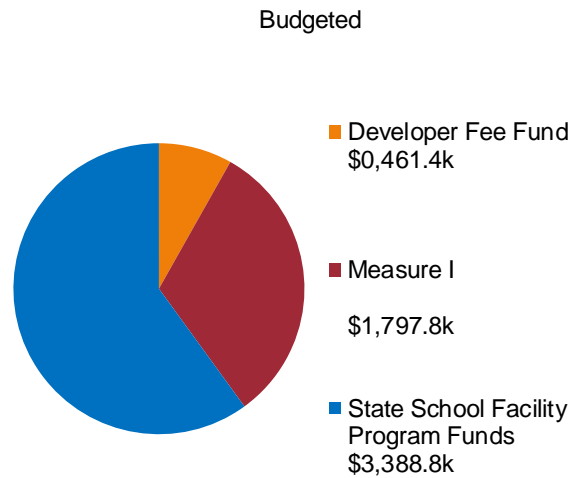



Heninger K-8 School

417 W. Walnut Ave. Santa Ana, CA 92701

Modernization

Project Description

Heninger K-8 was built in 1992. The site has 41 classrooms. Modernization will address dated infrastructure and ADA accessibility.

Architect:	SVA Architects
DSA Status:	Approved
Project Status:	Pending State Bond Funds
Measure I Budget:	\$1,997,496
Total Budget:	\$6,266,307

Status Summary

The project was State approved in early 2019 and is currently pending State matching funds which are anticipated in 2020 or thereafter. Once funds are allocated by the State Allocation Board, the District will begin bidding and preparation for construction.



Heninger K-8 School

417 W. Walnut Ave. Santa Ana, CA 92701

Modernization

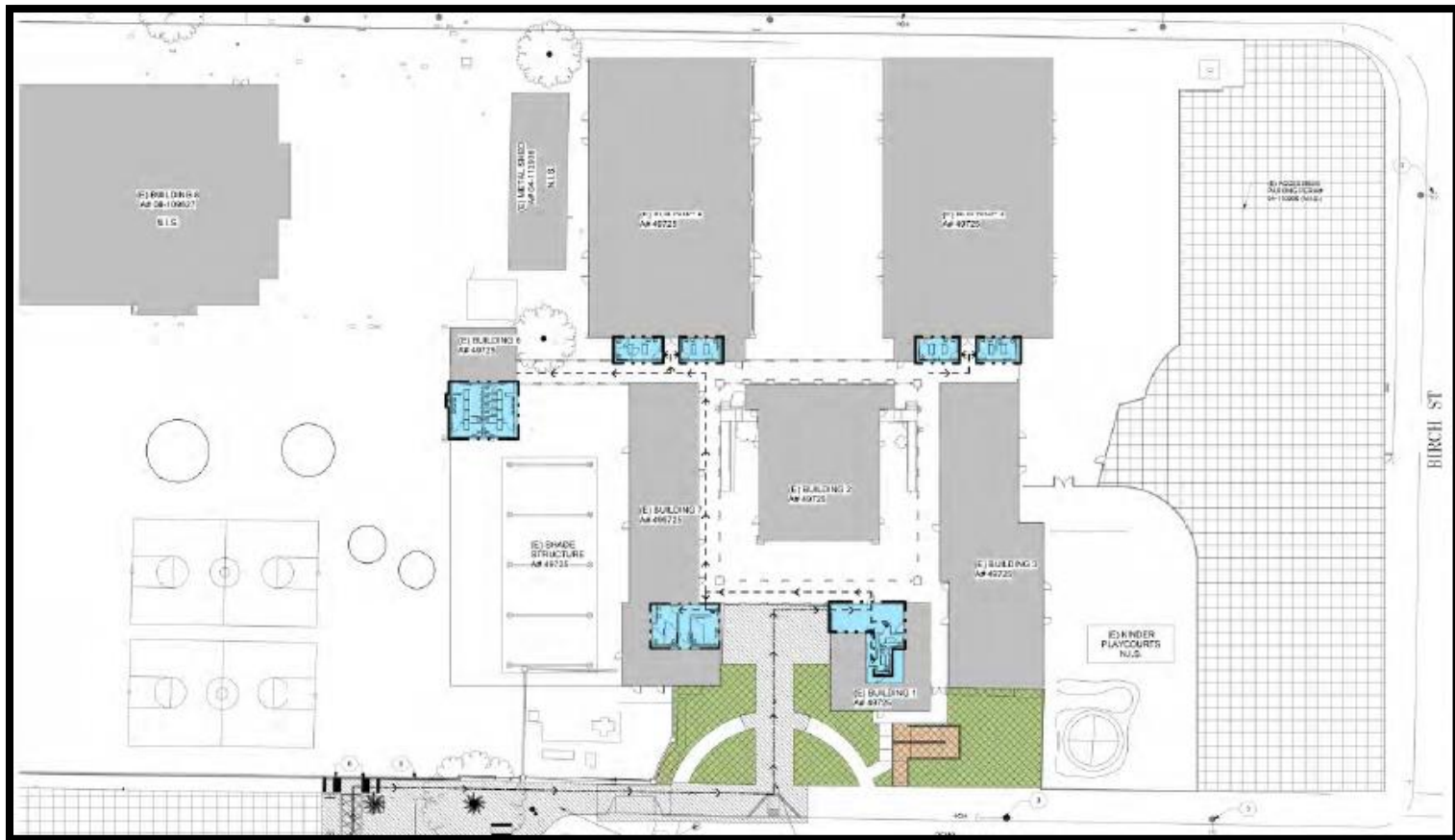



Heninger K-8 School

417 W. Walnut Ave. Santa Ana, CA 92701

Modernization

Summary Status

Description	Budgeted	Committed	Expended
Site Cost	-	-	-
Soft Cost	1,089,707	509,027	390,330
Hard Cost	4,276,755	-	-
Contingency	899,845	-	-
Total	6,266,307	509,027	390,330

Budgeted Hard Cost 68.2%

Budget Status

Initial Amount	6,266,307
Pending Changes	-
Total	6,266,307

Budgeted Contingency 14.4%

Committed Status

Initial Contracted AMT	495,505
Contract Changes	13,522 2.7%
Total	509,027

Budget Committed 8.1%

Expenditure Status

Paid	379,562
In Process for PMT	10,768
Total	390,330

Budget Expended 6.2%

Progress

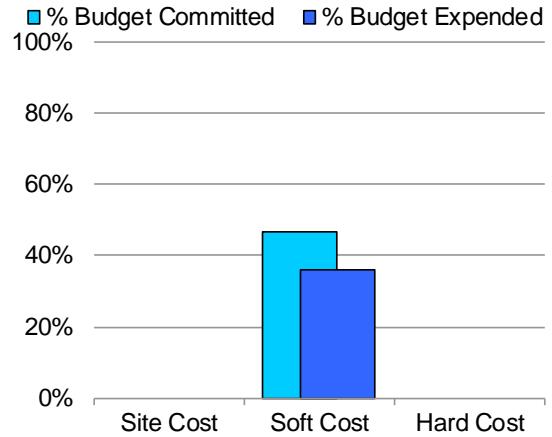

Funding Sources

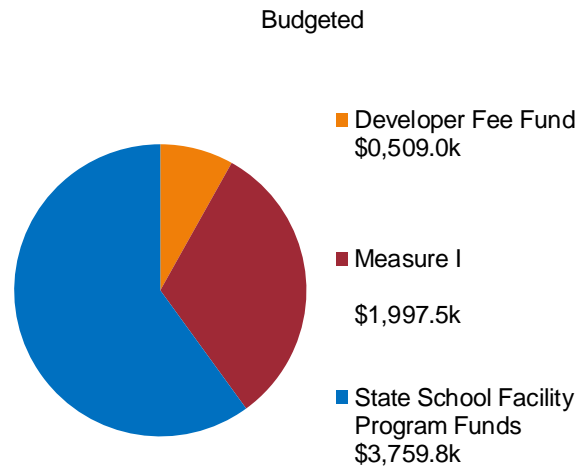



Kennedy Elementary School

1300 E. McFadden Ave. Santa Ana, CA 92705

Modernization

Project Description

Kennedy Elementary School was originally built in 1990. The site has 46 classrooms. Modernization will address dated infrastructure and ADA accessibility.

Architect:	SVA Architects
DSA Status:	Pending Submittal
Project Status:	Pending State Bond Funds
Measure I Budget:	\$1,657,094
Total Budget:	\$5,222,614

Status Summary

The project was State approved in early 2019 and is currently pending State matching funds which are anticipated in 2020 or thereafter. Once funds are allocated by the State Allocation Board, the District will begin bidding and preparation for construction.



Kennedy Elementary School

1300 E. McFadden Ave. Santa Ana, CA 92705

Modernization





Kennedy Elementary School

1300 E. McFadden Ave. Santa Ana, CA 92705

Modernization

Summary Status

Description	Budgeted	Committed	Expended
Site Cost	-	-	-
Soft Cost	915,697	431,952	329,477
Hard Cost	3,564,434	-	-
Contingency	742,483	-	-
Total	5,222,614	431,952	329,477

Budgeted Hard Cost 68.2%

Budget Status

Initial Amount	5,222,614
Pending Changes	-
Total	5,222,614

Budgeted Contingency 14.2%

Committed Status

Initial Contracted AMT	260,650
Contract Changes	171,302 39.7%
Total	431,952

Budget Committed 8.3%

Expenditure Status

Paid	321,480
In Process for PMT	7,997
Total	329,477

Budget Expended 6.3%

Progress

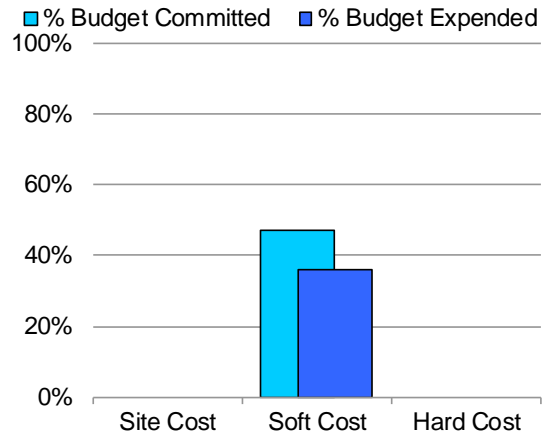

Funding Sources

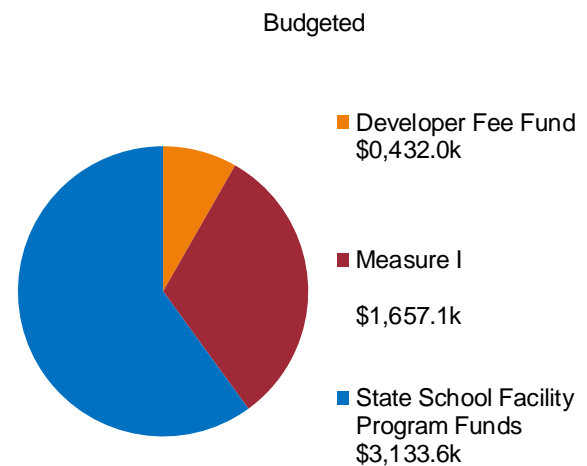



Pio Pico Elementary School

931 W. Highland St. Santa Ana, CA 92705

Modernization

Project Description

Pio Pico Elementary was originally built in 1991. The site has 22 classrooms. Modernization will address dated infrastructure and ADA accessibility.

Architect:	SVA Architects
DSA Status:	Approved
Bidding & Award:	Pending State Bond Funds
Measure I Budget:	\$1,910,342
Project Budget:	\$6,012,773

Status Summary

The project was State approved in early 2019 and is currently pending State matching funds which are anticipated in 2020 or thereafter. Once funds are allocated by the State Allocation Board, the District will begin bidding and preparation for construction.



Pio Pico Elementary School

931 W. Highland St. Santa Ana, CA 92705

Modernization

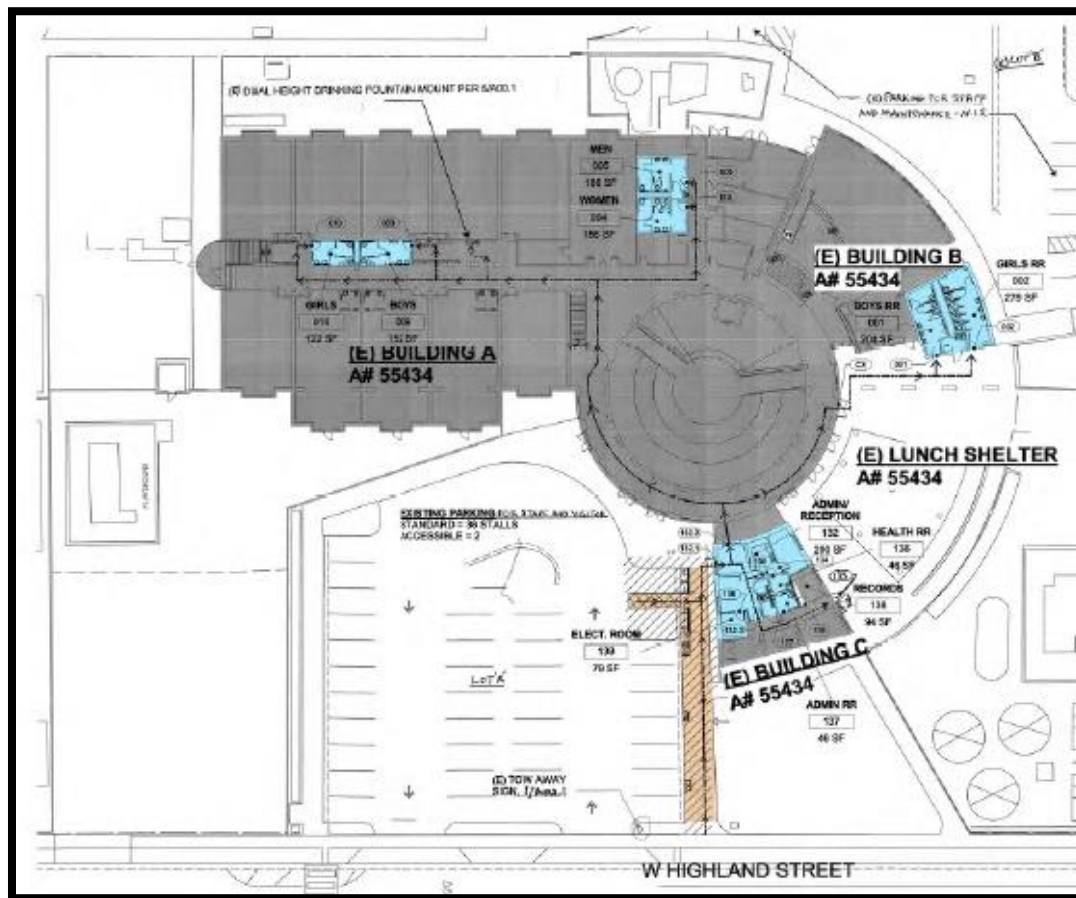



Pio Pico Elementary School

931 W. Highland St. Santa Ana, CA 92705

Modernization

Summary Status

Description	Budgeted	Committed	Expended
Site Cost	-	-	-
Soft Cost	1,051,700	494,767	374,205
Hard Cost	4,103,718	-	-
Contingency	857,355	-	-
Total	6,012,773	494,767	374,205

Budgeted Hard Cost 68.2%

Budget Status

Initial Amount	6,012,773
Pending Changes	-
Total	6,012,773

Budgeted Contingency 14.3%

Committed Status

Initial Contracted AMT	298,917	
Contract Changes	195,850	39.6%
Total	494,767	

Budget Committed 8.2%

Expenditure Status

Paid	374,205
Total	374,205

Budget Expended 6.2%

Progress

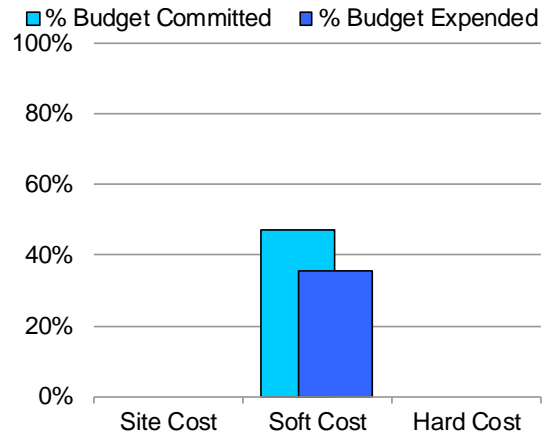

Funding Sources

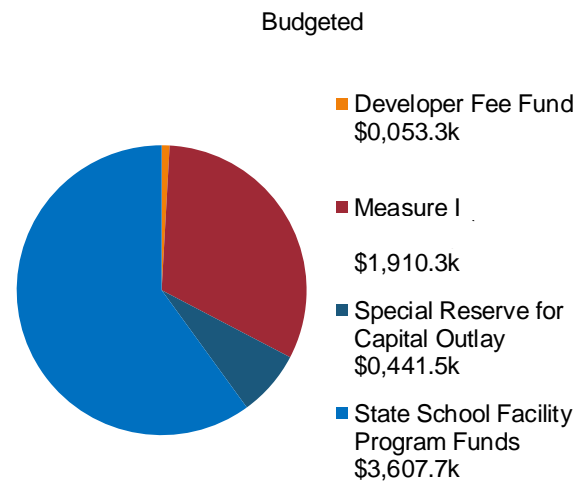



Walker Elementary School

811 E. Bishop Ave. Santa Ana, CA 92707

Modernization

Project Description

Walker Elementary School was originally built in 1993. The site has 23 classrooms. Modernization will address dated infrastructure and Americans with Disabilities Act (ADA) accessibility.

Architect:	SVA Architects
DSA Status:	Approved
Project Status:	Pending State Bond Funds
Measure I Budget:	\$1,172,190
Total Budget:	\$3,740,956

Status Summary

The project was State approved in early 2019 and is currently pending State matching funds which are anticipated in 2020 or thereafter. Once funds are allocated by the State Allocation Board, the District will begin bidding and preparation for construction.



Walker Elementary School

811 E. Bishop Ave. Santa Ana, CA 92707

Modernization

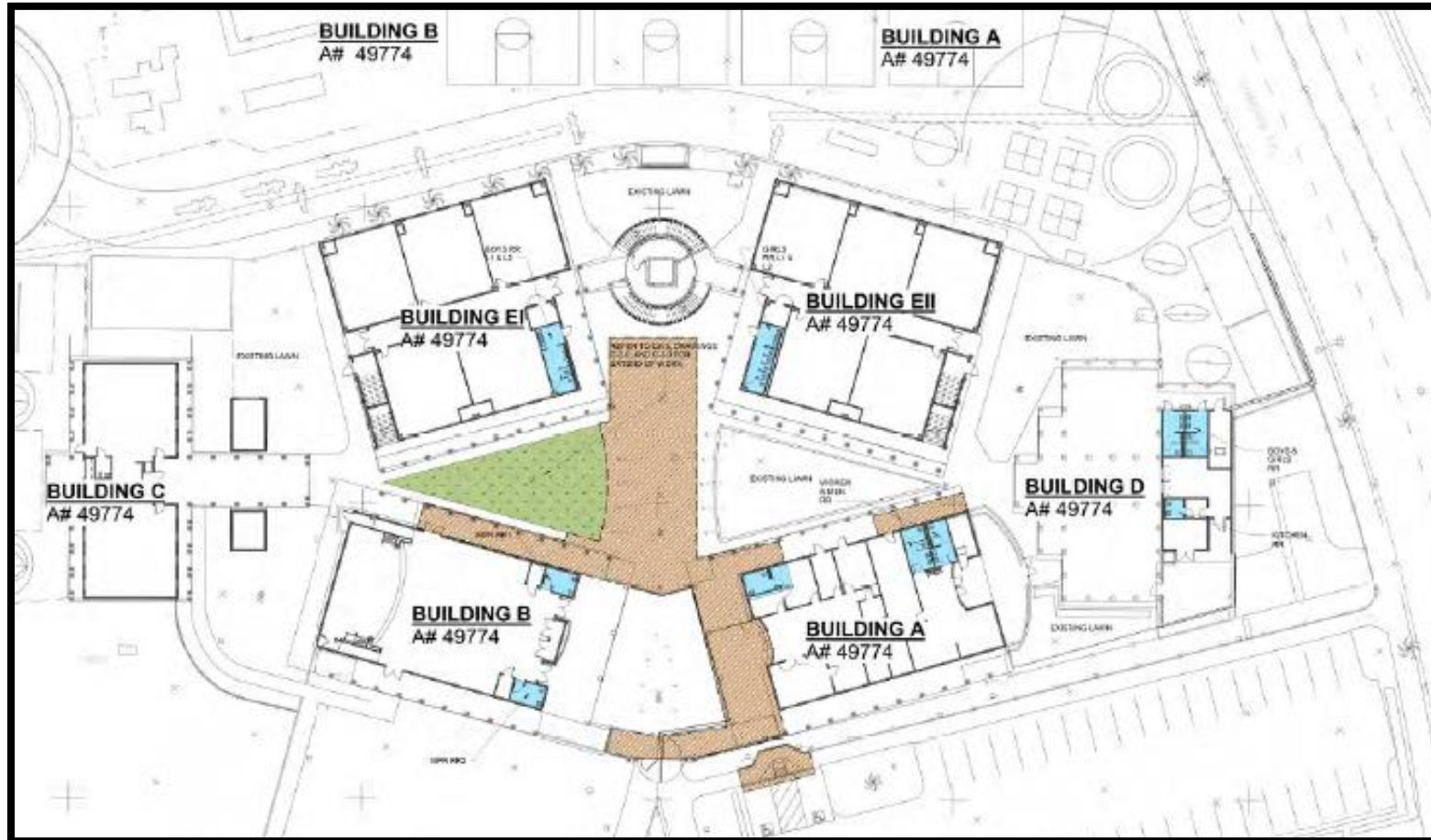



Walker Elementary School

811 E. Bishop Ave. Santa Ana, CA 92707

Modernization

Summary Status

Description	Budgeted	Committed	Expended
Site Cost	-	-	-
Soft Cost	742,218	324,192	241,597
Hard Cost	2,998,738	-	-
Contingency	-	-	-
Total	3,740,956	324,192	241,597
Budgeted Hard Cost 80.2%			

Budget Status

Initial Amount	3,740,956
Pending Changes	-
Total	3,740,956
Budgeted Contingency 0.0%	

Committed Status

Initial Contracted AMT	292,050	
Contract Changes	32,142	9.9%
Total	324,192	
Budget Committed 8.7%		

Expenditure Status

Paid	241,597
Total	241,597
Budget Expended 6.5%	

Progress

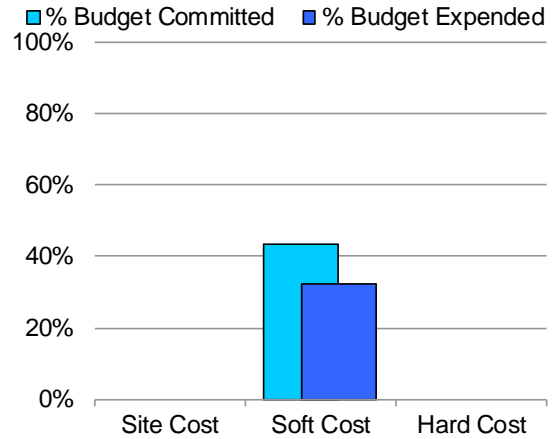

Funding Sources

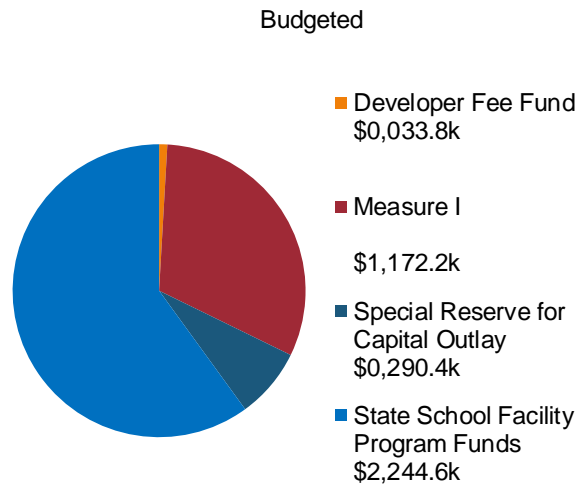



Villa Fundamental Intermediate School

1441 E. Chestnut Ave. Santa Ana, CA 92701

Modernization

Project Description

Villa Fundamental Intermediate School was built in 1998. Modernization will provide new science labs, a new front entry and office, expanded shelter, new HVAC system, Americans with Disabilities Act (ADA) access improvements, and infrastructure upgrades.

Architect:	Baker Nowicki
DSA Status:	Pending Submittal
Project Status:	Construction Documents
Measure I Budget:	\$8,487,610
Total Budget:	\$16,399,600

Status Summary

The Design team has completed approximately 70% of the design process and anticipates submittal to the State in fall 2019. Thereafter, approximately 4-6 months of State review is anticipated. Once State funds are allocated by the State Allocation Board, the District will begin preparation for project bidding and Board approval.



Villa Fundamental Intermediate School

1441 E. Chestnut Ave. Santa Ana, CA 92701

Modernization





Villa Fundamental Intermediate School

1441 E. Chestnut Ave. Santa Ana, CA 92701

Modernization

Summary Status

Description	Budgeted	Committed	Expended
Site Cost	-	-	-
Soft Cost	3,044,999	1,412,102	862,731
Hard Cost	11,192,727	-	-
Contingency	2,161,874	-	-
Total	16,399,600	1,412,102	862,731
Budgeted Hard Cost 68.3%			

Budget Status

Initial Amount	16,399,600
Pending Changes	-
Total	16,399,600
Budgeted Contingency 13.2%	

Committed Status

Initial Contracted AMT	991,826	
Contract Changes	420,276	29.8%
Total	1,412,102	
Budget Committed 8.6%		

Expenditure Status

Paid	862,731
Total	862,731
Budget Expended 5.3%	

Progress

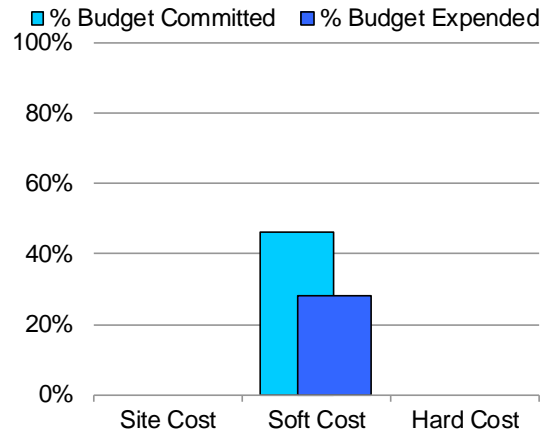

Funding Sources

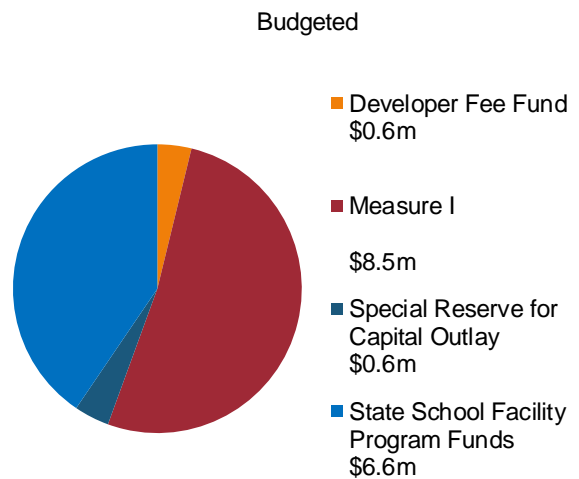



District Wide

Various sites

Marquee Installations

Phase II

Project Description

Electronic message boards installations will be designed and installed at the following sites: Franklin Elementary, Harvey Elementary, Jefferson Elementary, Lincoln Elementary, Monte Vista Elementary, Roosevelt Elementary, Taft Elementary, Walker Elementary, Wilson Elementary, Lorin Griset Academy, REACH Academy, and Segerstrom High.

Architect:	Lionakis Architecture (proposed)
DSA Status:	Pending Submittal
Project Status:	Planning/Design
Measure I Budget	\$1,000,000
Total Budget:	\$1,000,000

Status Summary

Planning staff is currently working with the architect to complete Phase I drawings. The same architect is proposed for Phase II, which may commence upon issuance of additional Measure I funding.



District Wide

Various sites

Marquee Installations

Phase II

Summary Status

Description	Budgeted	Committed	Expended
Site Cost	-	-	-
Soft Cost	178,600	-	-
Hard Cost	735,000	-	-
Contingency	86,400	-	-
Total	1,000,000	-	-

Budgeted Hard Cost 73.5%

Budget Status

Initial Amount	1,000,000
Pending Changes	-
Total	1,000,000

Budgeted Contingency 8.6%

Committed Status

No Commitments to report.

Expended Status

No Expenditures to report.

Progress

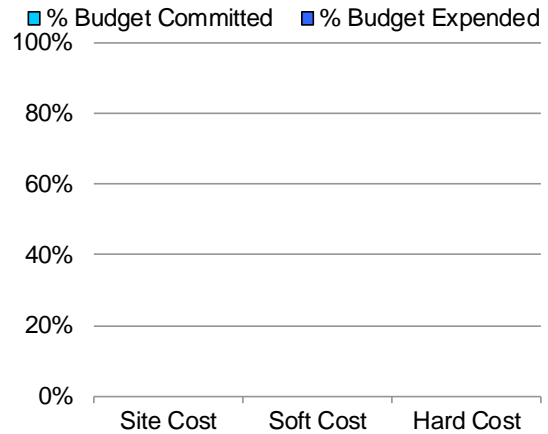

Funding Sources

Budgeted

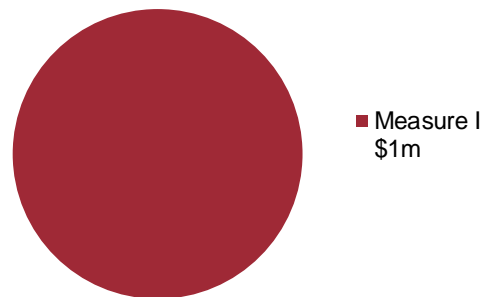



Godinez Fundamental High School

3002 Centennial Rd. Santa Ana, CA 92704

Aquatic Facility

Project Description

Godinez was originally built in 2003 without aquatic facilities equitable to other comprehensive high schools. This project will provide a competition style aquatic center for school and community use.

Architect:	Pending
DSA Status:	Pending Submittal
Project Status:	Pending Board Approval of Architect
Measure I Budget:	\$7,000,000
Total Budget:	\$7,000,000

Status Summary

Budget requirements suggest that sufficient Measure I funds are available to complete design and State approval, with construction funded from the second series of Measure I funds. Project design is projected to begin in late 2019.



Godinez Fundamental High School

3002 Centennial Rd. Santa Ana, CA 92704

Aquatic Facility

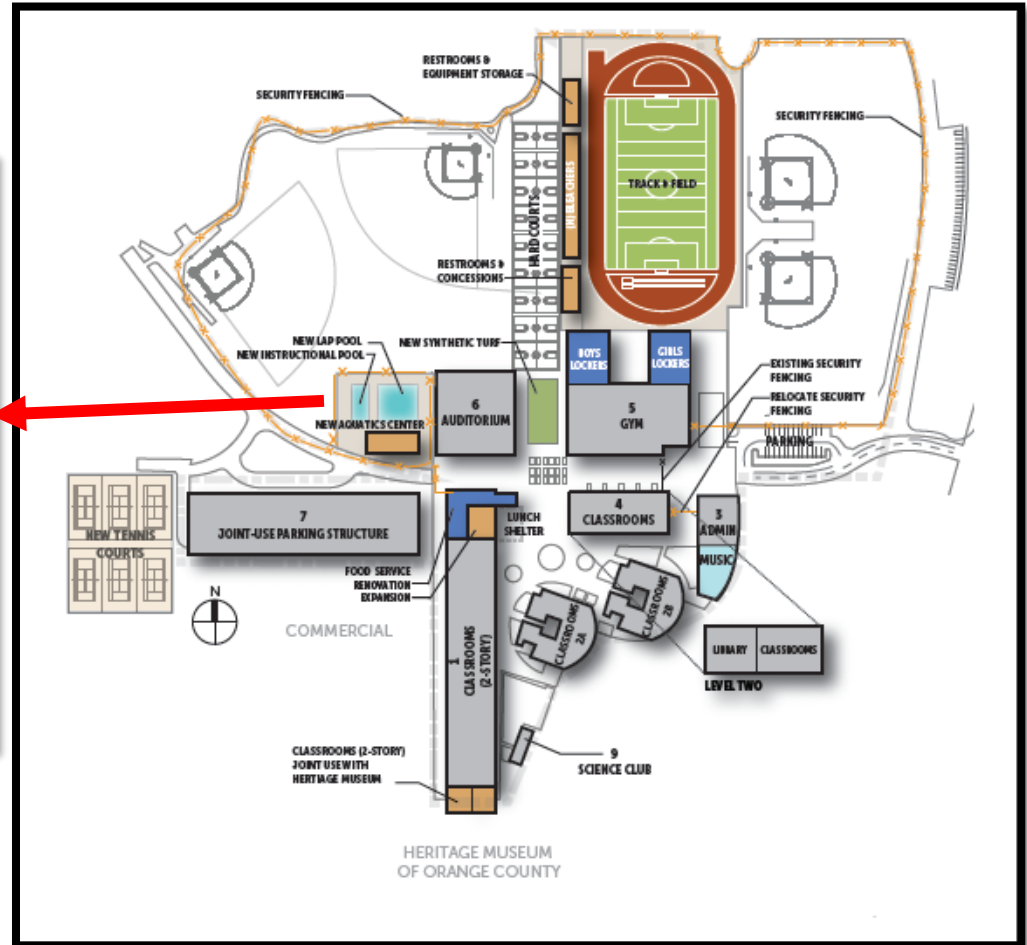
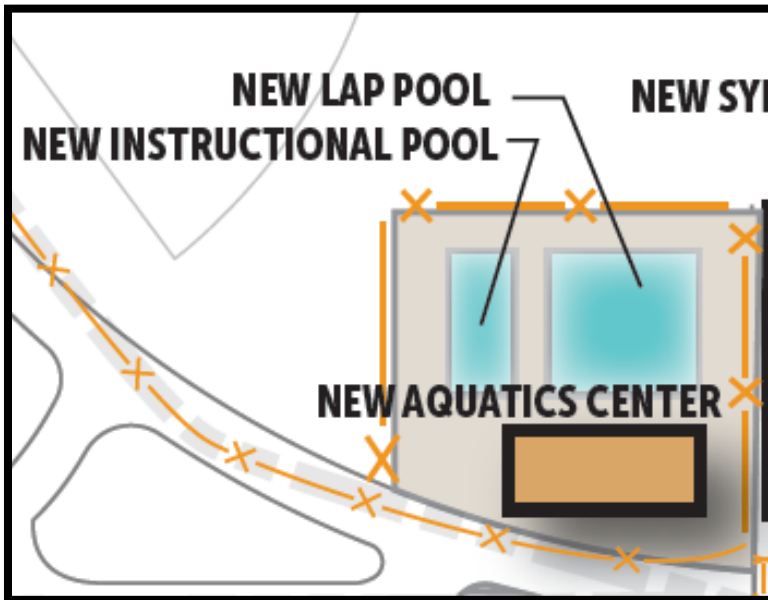



Godinez Fundamental High School

3002 Centennial Rd. Santa Ana, CA 92704

Aquatic Facility

Summary Status

Description	Budgeted	Committed	Expended
Site Cost	-	-	-
Soft Cost	1,160,250	-	-
Hard Cost	4,777,500	-	-
Contingency	1,062,250	-	-
Total	7,000,000	-	-

Budgeted Hard Cost 68.3%

Budget Status

Initial Amount	7,000,000
Pending Changes	-
Total	7,000,000

Budgeted Contingency 15.2%

Committed Status

No Commitments to report.

Expended Status

No Expenditures to report.

Progress

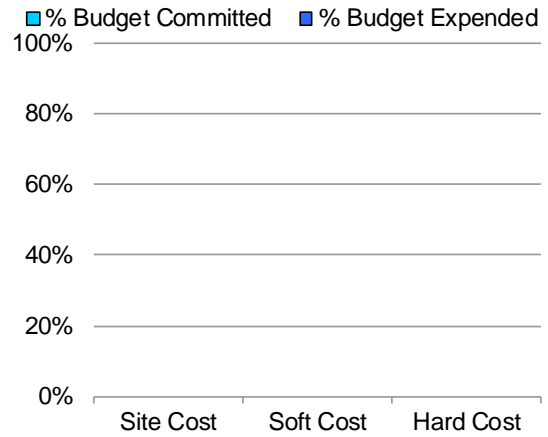

Funding Sources

Budgeted

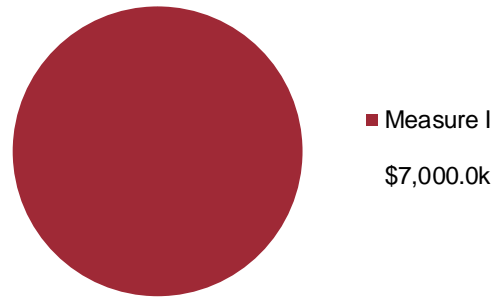



MEASURE I PROGRAM EXECUTIVE SUMMARY

School Name - Project Name	Measure I Budget	Commitments	Expenditures	Remaining Against Budget	%	Declining Balance
Measure I First Issuance Series A						59,503,000
Interest Revenue						211,318
Total Available Fund						59,714,318
Measure I Program Administration and Reserves	15,561,064	830,928	198,248	15,362,816	99%	44,153,254
Santa Ana High - Measure I CTE Digital Media Arts Lab/Library	50,000	-	-	50,000	100%	44,103,254
Carver Elementary - Measure I P2P	980,391	-	-	980,391	100%	43,122,863
Muir Fundamental - Measure I ORG P2P	759,154	-	-	759,154	100%	42,363,709
Carver Elementary - Measure I Modernization	8,815,632	211,299	40,855	8,774,777	100%	33,548,077
Garfield Elementary - Measure I Modernization	7,669,956	230,307	45,510	7,624,446	99%	25,878,121
King Elementary - Measure I Modernization	6,592,852	207,338	37,321	6,555,531	99%	19,285,269
Saddleback High - Measure I Kitchen/Indoor Dining & Interim Kitchen	2,900,000	-	-	2,900,000	100%	16,385,269
Heninger K-8 - Measure I Music Expansion	2,176,821	-	-	2,176,821	100%	14,208,448
District Wide - Measure I DW Marquee (phase I)	1,000,000	108,600	10,500	989,500	99%	13,208,448
Jackson ES - Measure I Preschool Lab	1,100,507	140,775	17,320	1,083,187	98%	12,107,941
District Wide - Measure I Single Point of Entry/Security (phase I)	3,336,336	-	-	3,336,336	100%	8,771,605
Valley High - Measure I CTE Culinary Arts Building	3,000,000	-	-	3,000,000	100%	5,771,605
Washington Elementary - Measure I Reconstruction (Design only)	544,509	521,255	78,189	466,320	86%	5,227,096
Saddleback High - Measure I Sports Center (Design only)	1,001,774	-	-	1,001,774	100%	4,225,322
Valley High - Measure I Auditorium Renovation (Design only)	1,352,558	-	-	1,352,558	100%	2,872,764
Jefferson Elementary - Measure I P2P (Design only)	1,500,000	-	-	1,500,000	100%	1,372,764
Washington Elementary - Measure I Reconstruction (Construction)	13,306,454	-	-	13,306,454	100%	(11,933,690)
Saddleback High - Measure I Sports Center (Construction)	12,309,279	-	-	12,309,279	100%	(24,242,969)
Valley High - Measure I Auditorium Renovation (Construction)	17,969,702	-	-	17,969,702	100%	(42,212,671)
Jefferson Elementary - Measure I P2P (Construction)	22,644,577	-	-	22,644,577	100%	(64,857,248)
ALA I / EB Cole - Measure I Single Point of Entry & New Kitchen	2,716,290	-	-	2,716,290	100%	(67,573,538)
Century High - Measure I Modernization	5,849,163	-	-	5,849,163	100%	(73,422,701)
Santa Ana High - Measure I Modernization	6,259,505	-	-	6,259,505	100%	(79,682,206)
Chavez High - Measure I Modernization	692,144	-	-	692,144	100%	(80,374,350)
Davis Elementary - Measure I Modernization	1,797,767	-	-	1,797,767	100%	(82,172,117)
Heninger Elementary - Measure I Modernization	1,997,496	-	-	1,997,496	100%	(84,169,613)
Kennedy Elementary - Measure I Modernization	1,657,094	-	-	1,657,094	100%	(85,826,707)
Pio Pico Elementary - Measure I Modernization	1,910,342	-	-	1,910,342	100%	(87,737,049)
Walker Elementary - Measure I Modernization	1,172,190	-	-	1,172,190	100%	(88,909,239)
Villa Fundamental - Measure I Modernization	8,487,610	142,450	99,950	8,387,660	99%	(97,396,849)
District Wide - Measure I DW Marquee (phase II)	1,000,000	-	-	1,000,000	100%	(98,396,849)
District Wide - Measure I Single PE/Security (phase II,III,IV)	11,143,008	-	-	11,143,008	100%	(109,539,857)
Godinez Fundamental High - Measure I Aquatic Facility	7,000,000	-	-	7,000,000	100%	(116,539,857)
	176,254,175	2,392,952	527,893	175,726,282	100%	



Citizens' Oversight Committee Report – November 18, 2019
DETAILED PROGRAM EXPENDITURES

School Name - Project Name	Measure I			Other(s)			Grand Total		
	Budget	Commitments	Expenditures	Budget	Commitments	Expenditures	Budget	Commitments	Expenditures
Program - Measure I Program Administration and Reserves									
Budget Total	15,561,064	-	-	198,999	-	-	15,760,063	-	-
B - Planning Total	-	830,928	198,248	-	198,998	175,638	-	1,029,926	373,887
	15,561,064	830,928	198,248	198,999	198,998	175,638	15,760,063	1,029,926	373,887
Santa Ana High - Measure I CTE Digital Media Arts Lab/Library									
Budget Total	50,000	-	-	5,658,225	-	-	5,708,225	-	-
B - Planning Total	-	-	-	-	634,077	498,889	-	634,077	498,889
C - Construction Total	-	-	-	-	4,743,597	4,571,468	-	4,743,597	4,571,468
D - Testing Total	-	-	-	-	3,702	3,702	-	3,702	3,702
E - Inspection Total	-	-	-	-	225,792	135,000	-	225,792	135,000
	50,000	-	-	5,658,225	5,607,168	5,209,059	5,708,225	5,607,168	5,209,059
Carver Elementary - Measure I P2P									
Budget Total	980,391	-	-	10,186,987	-	-	11,167,378	-	-
A - Site Total	-	-	-	-	20,534	18,259	-	20,534	18,259
B - Planning Total	-	-	-	-	625,016	574,757	-	625,016	574,757
C - Construction Total	-	-	-	-	9,925,168	6,320,966	-	9,925,168	6,320,966
E - Inspection Total	-	-	-	-	368,778	257,579	-	368,778	257,579
	980,391	-	-	10,186,987	10,939,496	7,171,561	11,167,378	10,939,496	7,171,561
Muir Fundamental - Measure I ORG P2P									
Budget Total	759,154	-	-	20,000,000	-	-	20,759,154	-	-
B - Planning Total	-	-	-	-	1,064,920	829,399	-	1,064,920	829,399
C - Construction Total	-	-	-	-	17,832,350	3,744,045	-	17,832,350	3,744,045
D - Testing Total	-	-	-	-	90,626	18,193	-	90,626	18,193
E - Inspection Total	-	-	-	-	139,464	-	-	139,464	-
	759,154	-	-	20,000,000	19,127,360	4,591,637	20,759,154	19,127,360	4,591,637
Carver Elementary - Measure I Modernization									
Budget Total	8,815,632	-	-	762,174	-	-	9,577,806	-	-
B - Planning Total	-	3,440	3,440	-	719,707	507,699	-	723,147	511,139
C - Construction Total	-	207,859	37,415	-	-	-	-	207,859	37,415
	8,815,632	211,299	40,855	762,174	719,707	507,699	9,577,806	931,006	548,554
Garfield Elementary - Measure I Modernization									
Budget Total	7,669,956	-	-	577,513	-	-	8,247,469	-	-
B - Planning Total	-	4,945	4,945	-	577,513	453,293	-	582,458	458,238
C - Construction Total	-	225,362	40,565	-	-	-	-	225,362	40,565
	7,669,956	230,307	45,510	577,513	577,513	453,293	8,247,469	807,820	498,803
King Elementary - Measure I Modernization									
Budget Total	6,592,852	-	-	596,010	-	-	7,188,862	-	-
B - Planning Total	-	-	-	-	596,010	461,984	-	596,010	461,984
C - Construction Total	-	207,338	37,321	-	-	-	-	207,338	37,321
	6,592,852	207,338	37,321	596,010	596,010	461,984	7,188,862	803,348	499,305
Saddleback High - Measure I Kitchen/Indoor Dining & Interim Kitchen									
Budget Total	2,900,000	-	-	8,600,000	-	-	11,500,000	-	-
B - Planning Total	-	-	-	-	949,091	727,854	-	949,091	727,854
C - Construction Total	-	-	-	-	1,327,333	40,212	-	1,327,333	40,212
	2,900,000	-	-	8,600,000	2,276,424	768,066	11,500,000	2,276,424	768,066
Heninger K-8 - Measure I Music Expansion									
Budget Total	2,176,821	-	-	257,326	-	-	2,434,147	-	-
B - Planning Total	-	-	-	-	257,326	187,329	-	257,326	187,329
	2,176,821	-	-	257,326	257,326	187,329	2,434,147	257,326	187,329



Citizens' Oversight Committee Report – November 18, 2019
DETAILED PROGRAM EXPENDITURES

School Name - Project Name	Measure I			Other(s)			Grand Total		
	Budget	Commitments	Expenditures	Budget	Commitments	Expenditures	Budget	Commitments	Expenditures
District Wide - Measure I DW Marquee (phase I)									
<i>Budget Total</i>	1,000,000	-	-	-	-	-	1,000,000	-	-
<i>B - Planning Total</i>	-	108,600	10,500	-	-	-	-	108,600	10,500
	1,000,000	108,600	10,500				1,000,000	108,600	10,500
Jackson ES - Measure I Preschool Lab									
<i>Budget Total</i>	1,100,507	-	-	-	-	-	1,100,507	-	-
<i>B - Planning Total</i>	-	140,775	17,320	-	-	-	-	140,775	17,320
	1,100,507	140,775	17,320				1,100,507	140,775	17,320
District Wide - Measure I Single Point of Entry/Security (phase I)									
<i>Budget Total</i>	3,336,336	-	-	378,000	-	-	3,714,336	-	-
<i>B - Planning Total</i>	-	-	-	-	378,000	262,450	-	378,000	262,450
	3,336,336			378,000	378,000	262,450	3,714,336	378,000	262,450
Valley High - Measure I CTE Culinary Arts Building									
<i>Budget Total</i>	3,000,000	-	-	3,000,000	-	-	6,000,000	-	-
	3,000,000			3,000,000			6,000,000		
Washington Elementary - Measure I Reconstruction									
<i>Budget Total</i>	13,850,963	-	-	5,191,492	-	-	19,042,455	-	-
<i>B - Planning Total</i>	-	-	-	-	955,491	688,434	-	955,491	688,434
<i>C - Construction Total</i>	-	521,255	78,189	-	-	-	-	521,255	78,189
	13,850,963	521,255	78,189	5,191,492	955,491	688,434	19,042,455	1,476,746	766,623
Saddleback High - Measure I Sports Center									
<i>Budget Total</i>	13,311,053	-	-	1,000,000	-	-	14,311,053	-	-
	13,311,053			1,000,000			14,311,053		
Valley High - Measure I Auditorium Renovation									
<i>Budget Total</i>	19,322,260	-	-	-	-	-	19,322,260	-	-
	19,322,260						19,322,260		
Jefferson Elementary - Measure I P2P									
<i>Budget Total</i>	24,144,577	-	-	-	-	-	24,144,577	-	-
	24,144,577						24,144,577		
ALA I / EB Cole - Measure I Single Point of Entry & New Kitchen									
<i>Budget Total</i>	2,716,290	-	-	145,050	-	-	2,861,340	-	-
<i>B - Planning Total</i>	-	-	-	-	145,050	92,324	-	145,050	92,324
	2,716,290			145,050	145,050	92,324	2,861,340	145,050	92,324
Century High - Measure I Modernization									
<i>Budget Total</i>	5,849,163	-	-	13,922,266	-	-	19,771,429	-	-
<i>B - Planning Total</i>	-	-	-	-	2,059,409	1,532,272	-	2,059,409	1,532,272
	5,849,163			13,922,266	2,059,409	1,532,272	19,771,429	2,059,409	1,532,272
Santa Ana High - Measure I Modernization									
<i>Budget Total</i>	6,259,505	-	-	14,740,495	-	-	21,000,000	-	-
<i>B - Planning Total</i>	-	-	-	-	2,140,495	1,571,853	-	2,140,495	1,571,853
	6,259,505			14,740,495	2,140,495	1,571,853	21,000,000	2,140,495	1,571,853
Chavez High - Measure I Modernization									
<i>Budget Total</i>	692,144	-	-	1,547,810	-	-	2,239,954	-	-
<i>B - Planning Total</i>	-	-	-	-	209,242	165,458	-	209,242	165,458
	692,144			1,547,810	209,242	165,458	2,239,954	209,242	165,458
Davis Elementary - Measure I Modernization									
<i>Budget Total</i>	1,797,767	-	-	3,850,193	-	-	5,647,960	-	-
<i>B - Planning Total</i>	-	-	-	-	461,417	358,325	-	461,417	358,325
	1,797,767			3,850,193	461,417	358,325	5,647,960	461,417	358,325



Citizens' Oversight Committee Report – November 18, 2019
DETAILED PROGRAM EXPENDITURES

School Name - Project Name	Measure I			Other(s)			Grand Total		
	Budget	Commitments	Expenditures	Budget	Commitments	Expenditures	Budget	Commitments	Expenditures
Heninger Elementary - Measure I Modernization									
<i>Budget Total</i>	1,997,496	-	-	4,268,811	-	-	6,266,307	-	-
<i>B - Planning Total</i>	-	-	-	-	509,027	390,330	-	509,027	390,330
	1,997,496	-	-	4,268,811	509,027	390,330	6,266,307	509,027	390,330
Kennedy Elementary - Measure I Modernization									
<i>Budget Total</i>	1,657,094	-	-	3,565,520	-	-	5,222,614	-	-
<i>B - Planning Total</i>	-	-	-	-	431,952	329,477	-	431,952	329,477
	1,657,094	-	-	3,565,520	431,952	329,477	5,222,614	431,952	329,477
Pio Pico Elementary - Measure I Modernization									
<i>Budget Total</i>	1,910,342	-	-	4,102,431	-	-	6,012,773	-	-
<i>B - Planning Total</i>	-	-	-	-	494,767	374,205	-	494,767	374,205
	1,910,342	-	-	4,102,431	494,767	374,205	6,012,773	494,767	374,205
Walker Elementary - Measure I Modernization									
<i>Budget Total</i>	1,172,190	-	-	2,568,766	-	-	3,740,956	-	-
<i>B - Planning Total</i>	-	-	-	-	324,192	241,597	-	324,192	241,597
	1,172,190	-	-	2,568,766	324,192	241,597	3,740,956	324,192	241,597
Villa Fundamental - Measure I Modernization									
<i>Budget Total</i>	8,487,610	-	-	7,911,990	-	-	16,399,600	-	-
<i>B - Planning Total</i>	-	142,450	142,450	-	1,269,652	859,687	-	1,412,102	1,002,137
	8,487,610	142,450	142,450	7,911,990	1,269,652	859,687	16,399,600	1,412,102	1,002,137
District Wide - Measure I DW Marquee (phase II)									
<i>Budget Total</i>	1,000,000	-	-	-	-	-	1,000,000	-	-
	1,000,000	-	-	-	-	-	1,000,000	-	-
District Wide - Measure I Single PE/Security (phase II,III,IV)									
<i>Budget Total</i>	11,143,008	-	-	-	-	-	11,143,008	-	-
	11,143,008	-	-	-	-	-	11,143,008	-	-
Godinez Fundamental High - Measure I Aquatic Facility									
<i>Budget Total</i>	7,000,000	-	-	-	-	-	7,000,000	-	-
	7,000,000	-	-	-	-	-	7,000,000	-	-
Totals	176,254,175	2,392,952	570,393	113,030,058	49,678,693	26,392,680	289,284,233	52,071,645	26,963,073